

 DITCH WITCH HDD PARTS AND SUPPORT CATALOG

TOTAL PERFORMANCE.



Архангельск (8182)63-90-72
Астана +7(7172)727-132
Белгород (4722)40-23-64
Брянск (4832)59-03-52
Владивосток (423)249-28-31
Волгоград (844)278-03-48
Вологда (8172)26-41-59
Воронеж (473)204-51-73
Екатеринбург (343)384-55-89
Иваново (4932)77-34-06
Ижевск (3412)26-03-58
Казань (843)206-01-48

Калининград (4012)72-03-81
Калуга (4842)92-23-67
Кемерово (3842)65-04-62
Киров (8332)68-02-04
Краснодар (861)203-40-90
Красноярск (391)204-63-61
Курск (4712)77-13-04
Липецк (4742)52-20-81
Магнитогорск (3519)55-03-13
Москва (495)268-04-70
Мурманск (8152)59-64-93
Набережные Челны (8552)20-53-41

Нижний Новгород (831)429-08-12
Новокузнецк (3843)20-46-81
Новосибирск (383)227-86-73
Орел (4862)44-53-42
Оренбург (3532)37-68-04
Пенза (8412)22-31-16
Пермь (342)205-81-47
Ростов-на-Дону (863)308-18-15
Рязань (4912)46-61-64
Самара (846)206-03-16
Санкт-Петербург (812)309-46-40
Саратов (845)249-38-78

Смоленск (4812)29-41-54
Сочи (862)225-72-31
Ставрополь (8652)20-65-13
Тверь (4822)63-31-35
Томск (3822)98-41-53
Тула (4872)74-02-29
Тюмень (3452)66-21-18
Ульяновск (8422)24-23-59
Уфа (347)229-48-12
Челябинск (351)202-03-61
Череповец (8202)49-02-64
Ярославль (4852)69-52-93

сайт: <http://www.ditch.nt-rt.ru/> || эл. почта: dhc@nt-rt.ru



DITCH WITCH Performance Parts

- 2 Bits
- 11 Beacon Housings
- 14 Transition Subs
- 15 Saver Subs
- 16 EZ Connects
- 18 Connectors
- 20 Drill Pipe
- 22 Quick Wrenches & Jaws
- 25 Backreamers
- 33 Nozzles
- 34 Pullers
- 37 Swivels
- 40 Tabs
- 41 Electronic Guidance
- 42 Pipe & Cable Locating
- 44 Vacuum Excavation
- 46 Piercing Tools

DITCH WITCH Bits

Ditch Witch bits are optimized not only for the soils they work in but also for the drills that drive them. So, you know that when you're drilling with any Ditch Witch drill and bit, you're getting the level of performance that only comes from components truly made for each other. Ditch Witch bits are tested in real work conditions and engineered to outperform and outlast any competitor's bit. And they're manufactured with the optimal amount and thickness and placement of carbide to maximize performance and value.

SAND BIT

WITH ITS SQUARE NOSE AND CARBIDE ADDED TO THE SURFACE AND CUTTING EDGE, THE SAND BIT IS IDEAL FOR SOFT SOIL AND SANDY CONDITIONS.

PART NUMBER	CUT	BOLT PATTERN	BOLT SIZE	THICKNESS	BEND ANGLE
369-167	2.5 IN	3 HOLE	12 MM	1/2 IN	0°
368-897	3 IN	5 HOLE	12 MM	1/2 IN	10°
368-896	3 IN	5 HOLE	12 MM	1/2 IN	0°
369-078	4 IN	5 HOLE	12 MM	5/8 IN	10°
369-076	4 IN	5 HOLE	12 MM	5/8 IN	0°
369-080	5 IN	5 HOLE	12 MM	5/8 IN	10°



DURABIT

THE DURABIT IS DESIGNED TO PROVIDE EXTENDED WEAR IN ALL NON-ROCK SOIL FORMATIONS.

PART NUMBER	CUT	BOLT PATTERN	BOLT SIZE	THICKNESS	BEND ANGLE
369-169	2.5 IN	3 HOLE	12 MM	1/2 IN	0°
368-901	3 IN	5 HOLE	12 MM	5/8 IN	10°
368-900	3 IN	5 HOLE	12 MM	1/2 IN	10°
368-899	3 IN	5 HOLE	12 MM	5/8 IN	0°
368-898	3 IN	5 HOLE	12 MM	1/2 IN	0°
368-904	4 IN	5 HOLE	12 MM	3/4 IN	10°
368-903	4 IN	5 HOLE	12 MM	5/8 IN	10°
368-902	4 IN	5 HOLE	12 MM	1/2 IN	10°
369-082	5 IN	5 HOLE	12 MM	5/8 IN	10°
369-005	5 IN	6 HOLE	16 MM	3/4 IN	0°
368-980	5.2 IN	6 HOLE	20 MM	1 IN	0°
368-982	6.4 IN	6 HOLE	20 MM	1 IN	0°
368-720	6.4 IN	6 HOLE	16 MM	3/4 IN	0°
368-984	7.8 IN	6 HOLE	20 MM	1 IN	0°



TUFF BIT

ULTIMATE LONG-WEARING BIT FOR ALL SOIL CONDITIONS, INCLUDING HARD, COMPACTED SOILS OR SOFT, SEDIMENTARY ROCK. TUFF BIT SEGMENTS ALONG THE LEADING EDGE HAVE THE STRENGTH AND STABILITY TO HANDLE THE POUNDING AND VIBRATION OF DRILLING IN ROCK. THE BARRACUDA MATERIAL DOWN THE SIDES REDUCES WEAR ON THE NOSE OF THE HOUSING.

PART NUMBER	CUT	BOLT PATTERN	BOLT SIZE	THICKNESS	BEND ANGLE
369-727	3 IN	3 HOLE	12 MM	1/2 IN	0°
369-729	3 IN	5 HOLE	12 MM	5/8 IN	10°
401-334	3.5 IN	5 HOLE	12 MM	5/8 IN	10°
369-731	4 IN	5 HOLE	12 MM	5/8 IN	10°
400-172	4.5 IN	6 HOLE	16 MM	3/4 IN	10°
369-733	5 IN	5 HOLE	12 MM	5/8 IN	10°
369-735	5 IN	6 HOLE	16 MM	3/4 IN	10°
369-739	5 IN	6 HOLE	20 MM	1 IN	10°
369-737	6.4 IN	6 HOLE	16 MM	3/4 IN	10°
369-741	6.5 IN	6 HOLE	20 MM	1 IN	10°
369-743	8 IN	6 HOLE	20 MM	1 IN	10°



GRADE BIT

SHORTER AND NARROWER THAN OUR STANDARD BITS, THE GRADE BIT IS DESIGNED TO HELP THE DRILL HEAD STAY ON GRADE AND ALLOW STEERING CORRECTIONS TO BE EXECUTED MORE GRADUALLY.

PART NUMBER	CUT	BOLT PATTERN	BOLT SIZE	THICKNESS	BEND ANGLE
400-022	5 IN	6 HOLE	20 MM	1 IN	0°
400-021	5 IN	6 HOLE	20 MM	1 IN	0°
368-144	5.5 IN	6 HOLE	16 MM	3/4 IN	0°



BARRACUDA BIT

THE BARRACUDA BIT CAN BE USED IN MOST SOIL CONDITIONS, ESPECIALLY RUNNING SAND AND SANDY LOAM SOILS.

PART NUMBER	CUT	BOLT PATTERN	BOLT SIZE	THICKNESS	BEND ANGLE
369-171	2.5 IN	3 HOLE	12 MM	1/2 IN	0°
368-891	3 IN	5 HOLE	12 MM	5/8 IN	10°
368-890	3 IN	5 HOLE	12 MM	1/2 IN	10°
368-894	4 IN	5 HOLE	12 MM	3/4 IN	10°
368-893	4 IN	5 HOLE	12 MM	5/8 IN	10°
368-892	4 IN	5 HOLE	12 MM	1/2 IN	10°
369-067	5 IN	5 HOLE	12 MM	5/8 IN	10°
369-181	5 IN	6 HOLE	16 MM	3/4 IN	0°
369-468	5 IN	6 HOLE	16 MM	3/4 IN	10°
369-500	5.2 IN	6 HOLE	20 MM	1 IN	10°
369-498	5.2 IN	6 HOLE	20 MM	1 IN	0°
369-177	6.4 IN	6 HOLE	16 MM	3/4 IN	0°
369-469	6.4 IN	6 HOLE	16 MM	3/4 IN	10°
369-504	6.4 IN	6 HOLE	20 MM	1 IN	10°
369-502	6.4 IN	6 HOLE	20 MM	1 IN	0°
369-508	7.8 IN	6 HOLE	20 MM	1 IN	10°
369-506	7.8 IN	6 HOLE	20 MM	1 IN	0°



HARD SURFACE BIT

THE HARD SURFACE BIT CAN BE USED IN COBBLE AND CHUNK ROCK CONDITIONS, AND IS A GOOD CHOICE FOR WET AND SILTY CLAYS.

PART NUMBER	CUT	BOLT PATTERN	BOLT SIZE	THICKNESS	BEND ANGLE
369-068	3 IN	5 HOLE	12 MM	5/8 IN	10°
369-069	4 IN	5 HOLE	12 MM	5/8 IN	10°
369-070	5 IN	5 HOLE	12 MM	5/8 IN	10°



DITCH WITCH Bits

TORNADO BIT

LONG-LASTING, ALL-PURPOSE BIT DESIGNED FOR USE IN A VARIETY OF SOILS, INCLUDING SANDSTONE, CHUNK ROCK, AND HARD SOILS.

PART NUMBER	CUT	BOLT PATTERN	BOLT SIZE	THICKNESS	BEND ANGLE
400-1041	3 IN	5 HOLE	12 MM	5/8 IN	10°
400-1034	3.5 IN	5 HOLE	12 MM	5/8 IN	10°
400-1039	4 IN	5 HOLE	12 MM	5/8 IN	10°
400-1057	4 IN	5 HOLE	12 MM	3/4 IN	10°
400-1059	4.5 IN	6 HOLE	16 MM	3/4 IN	10°
400-1061	5 IN	6 HOLE	16 MM	3/4 IN	10°
400-1127	5 IN	6 HOLE	20 MM	1 IN	10°
400-1129	6 IN	6 HOLE	20 MM	1 IN	10°
400-1063	6.4 IN	6 HOLE	16 MM	3/4 IN	10°



STEEP TAPER BIT

DESIGNED WITH A POINTED, TRIANGLE-SHAPED NOSE, THE STEEP TAPER BIT CAN BE USED IN HIGHLY COMPACTED SOIL, LIGHT ROCK AND COBBLE.

PART NUMBER	CUT	BOLT PATTERN	BOLT SIZE	THICKNESS	BEND ANGLE
369-315	2.5 IN	3 HOLE	12 MM	1/2 IN	0°
369-072	3 IN	5 HOLE	12 MM	5/8 IN	10°
400-160	4 IN	5 HOLE	12 MM	5/8 IN	10°
368-895	4 IN	5 HOLE	12 MM	5/8 IN	10°
400-217	4.5 IN	6 HOLE	16 MM	3/4 IN	0°
400-170	4.5 IN	6 HOLE	16 MM	3/4 IN	10°
369-074	5 IN	5 HOLE	12 MM	5/8 IN	10°
369-183	5 IN	6 HOLE	16 MM	3/4 IN	0°
369-466	5 IN	6 HOLE	16 MM	3/4 IN	10°
369-486	5.2 IN	6 HOLE	20 MM	1 IN	0°
369-179	6.4 IN	6 HOLE	16 MM	3/4 IN	0°
369-467	6.4 IN	6 HOLE	16 MM	3/4 IN	10°
369-490	6.4 IN	6 HOLE	20 MM	1 IN	0°
369-494	7.8 IN	6 HOLE	20 MM	1 IN	0°



STEEP TAPER TUFF BIT

DESIGNED FOR HARD, COMPACTED SOILS AND SOFT, SEDIMENTARY ROCK, THE STEEP TAPER TUFF BIT FEATURES A POINTED, TRIANGLE-SHAPED NOSE AND TUFF BIT SEGMENTS ALONG THE LEADING EDGE THAT HAVE THE STRENGTH AND STABILITY TO WITHSTAND THE POUNDING AND VIBRATION OF DRILLING IN ROCK.

PART NUMBER	CUT	BOLT PATTERN	BOLT SIZE	THICKNESS	BEND ANGLE
400-120	4 IN	5 HOLE	12 MM	3/4 IN	10°
400-122	4 IN	6 HOLE	16 MM	3/4 IN	10°
400-124	5 IN	6 HOLE	16 MM	3/4 IN	10°
400-431	6 IN	6 HOLE	20 MM	1 IN	10°



GLACIER BIT

THE GLACIER BIT'S STREAMLINED DESIGN, SMALL NOSE, AND STEEP, LARGE STEERING SURFACE ENABLE BETTER PUSHING AND STEERING IN HARD FORMATIONS. STRATEGICALLY PLACED CARBIDES PROLONG THE LIFE OF THIS BIT AND PROTECT THE LEADING EDGE OF THE HOUSING. WILL PUSH SMALLER ROCKS ASIDE OR BORE THROUGH LARGER ROCKS.

PART NUMBER	CUT	THREAD
369-458	5.4 IN	2.88-5 API
369-429	6.5 IN	3.5 API IF



RHINO ROCK BIT

THIS VERSATILE BIT IS DESIGNED FOR DRILLING IN SOFT TO MEDIUM ROCK AND IN SOIL, ELIMINATING THE NEED FOR FREQUENT BIT CHANGES AS SOIL CONDITIONS CHANGE. THE PATENTED RHINO ROCK BIT IS AVAILABLE AS A BOLT-ON OR THREAD-ON.

PART NUMBER	CUT	BOLT PATTERN	BOLT SIZE
400-163	3 IN	3 HOLE	12 MM
369-459	3.5 IN	5 HOLE	12 MM
369-511	3.9 IN	5 HOLE	12 MM
369-513	4.6 IN	6 HOLE	16 MM

PART NUMBER	CUT	THREAD
369-989	3.5 IN	3.5 API IF
369-463	5.4 IN	2.88-5 API



COBBLE BIT

AN EXCLUSIVE DESIGN OF THE DITCH WITCH ORGANIZATION, THE COBBLE BIT IS IDEAL FOR LOOSE ROCK OR GRAVEL CONDITIONS.

PART NUMBER	CUT	THREAD
400-972	5.5 IN	2.88 API



DITCH WITCH Bits

TALON BIT

THE NEW AND IMPROVED TALON BIT HAS A THREAD-ON SHANK THAT PROVIDES GREATER RELIABILITY AND DURABILITY IN TOUGH CONDITIONS, INCLUDING SANDSTONE, SHALE, AND CHUNK ROCK. THE TALON BIT HAS FOUR REPLACEABLE, CARBIDE-TIPPED CUTTING TEETH SET AT AN ANGLE TO MORE EFFECTIVELY CARVE INTO ROCK. CARBIDE BUTTONS IN ITS ABRASION-RESISTANT, STEEL-BIT BODY REDUCE WEAR WHEN WORKING IN TOUGH CONDITIONS.

PART NUMBER	CUT	THREAD
400-1084	4 IN	1.63-6
400-1104	4.5 IN	1.88-6
400-1109	5.5 IN	2.25-6
400-1113	6 IN	2.63-6



SOFT FORMATION BIT

THE SOFT FORMATION BIT IS USED IN SANDSTONE, SHALE, AND TIGHT OR COMPACTED CLAY. DESIGNED EXCLUSIVELY FOR DITCH WITCH ALL TERRAIN SYSTEMS.

PART NUMBER	CUT	THREAD
400-971	5.25 IN	2.88 API
400-1094	6.65 IN	2.88 API
400-683	7 IN	3.50 API



TRI-CONE BIT

THE MILL TOOTH (MT) TRI-CONE BIT FEATURES MILL TOOTH CONES DESIGNED TO CUT IN HARD, COMPACTED SOILS AND SOFT TO MEDIUM ROCK, WHILE OUR TCI (TUNGSTEN CARBIDE INSERT) BIT IS DESIGNED FOR MEDIUM TO HARD ROCK. BOTH BITS ARE USED WITH A JETTING ASSEMBLY, AND ARE ALSO COMPATIBLE WITH DITCH WITCH ALL TERRAIN SYSTEMS.

PART NUMBER	CUT	THREAD	DESCRIPTION	MAXIMUM HARDNESS
400-432	4.75 IN	2.88 API	MT	10,000 PSI
400-1356	4.75 IN	2.88 API	TCI HDS3	20,000 PSI
401-345	5.5 IN	2.88 API	TCI HDX40	20,000 PSI
401-349	5.5 IN	2.88 API	TCI HDS2	50,000 PSI
401-138	6.25 IN	3.5 API	TCI 500 VALUE	3000 PSI - 5000 PSI
401-139	6.25 IN	3.5 API	TCI 700 VALUE	3000 PSI - 5000 PSI
401-346	6.5 IN	3.5 API	TCI HDX30	25,000 PSI
401-347	6.5 IN	3.5 API	TCI XR40	50,000 PSI
401-361	6.5 IN	3.5 API	TCI HDS3	20,000 PSI



SLANT FACE DUAL JET ADAPTER

BY ACCEPTING A VARIETY OF BOLT-ON BITS, THE VERSATILE SLANT FACE DUAL JET ADAPTER CAN BE USED IN A WIDE RANGE OF SOIL CONDITIONS.

PART NUMBER	SIZE	DESCRIPTION
400-1086	2.5 IN	1.63-5 THREAD TO 5 HOLE 12 MM BOLT
400-1106	2.75 IN	1.88-6 THREAD TO 5 HOLE 12 MM BOLT
400-1074	3.38 IN	2.23-6 THREAD TO 6 HOLE 16 MM BOLT
400-1115	3.75 IN	2.63-6 THREAD TO 6 HOLE 20 MM BOLT
369-112	4.75 IN	3.5 API IF TO 6 HOLE 20 MM BOLT



NOTE: FOR BITS WITH CLEVIS HOLES, HERE ARE CORRESPONDING SIZES OF PULL HOLES.

3-HOLE BITS = .531 OR 1/2" CLEVIS

5-HOLE BITS = .688 OR 5/8" CLEVIS

6-HOLE, 16-MM BIT BOLTS = 1.125" OR 1" CLEVIS

6-HOLE, 20-MM BIT BOLTS = 1.25" OR 1" CLEVIS

SOIL CONDITION CHART

Key ● =Best ◐ =Better ○ =Good

THIS CHART HELPS YOU CHOOSE THE IDEAL DRILLING BIT FOR A PARTICULAR TYPE OF SOIL.

	Sandy Soil	Soft Soil	Medium Soil	Hard Soil	Chunk Rock	Soft Rock	Hard Rock
Sand Bit	●	◐					
Durabit	◐	◐	●	●			
Tuff Bit	◐	●	●	●	◐	○	
Barracuda Bit	◐	●	●	◐			
Hard Surface Bit	◐	●	◐	○			
Tornado Bit	◐	◐	●	●	◐	○	
Steep Taper Bit	○	○	◐	●	◐	○	
Steep Taper Tuff Bit	○	○	◐	●	●	○	
Glacier Bit				○	●	●	
Rhino Rock Bit			○	◐	○	●	○
Cobble Bit				◐	●	◐	
Talon Bit			◐	●	◐	●	
Soft Formation Bit				◐	◐	●	
Tri-Cone Bit						●	●

COMPATIBLE DITCH WITCH DRILLS

	JT520	JT920L	JT920J/921/921S	JT922	JT1220 MACH 1	JT1720 MACH 1	JT2020 MACH 1	JT2720 MACH 1	JT3020 MACH 1	JT4020 MACH 1	JT100/JT8020M1	JT2720 ALL TERRAIN	JT3020 ALL TERRAIN	JT4020 ALL TERRAIN	JT100 ALL TERRAIN
SAND BIT 369-167	•														
SAND BIT 368-897		•	•	•	•	•	•								
SAND BIT 368-896		•	•	•	•	•	•								
SAND BIT 369-078		•	•	•	•	•	•	•							
SAND BIT 369-076		•	•	•	•	•	•	•							
SAND BIT 369-080		•	•	•	•	•	•	•							
DURABIT 369-169	•														
DURABIT 368-901		•	•	•	•	•	•								
DURABIT 368-900		•	•	•	•	•	•								
DURABIT 368-899		•	•	•	•	•	•								
DURABIT 368-898		•	•	•	•	•	•								
DURABIT 368-904		•	•	•	•	•	•	•							
DURABIT 368-903		•	•	•	•	•	•	•							
DURABIT 368-902		•	•	•	•	•	•	•							
DURABIT 369-082		•	•	•	•	•	•	•							
DURABIT 369-005							•								
DURABIT 368-980									•	•					
DURABIT 368-982									•	•					
DURABIT 368-720							•								
DURABIT 368-984									•	•					
TUFF BIT 369-727	•														
TUFF BIT 369-729		•	•	•	•	•	•								
TUFF BIT 401-334		•	•	•	•	•	•								
TUFF BIT 369-731		•	•	•	•	•	•	•							
TUFF BIT 400-172							•	•							
TUFF BIT 369-733		•	•	•	•	•	•	•							
TUFF BIT 369-735							•	•							
TUFF BIT 369-739									•	•					
TUFF BIT 369-737							•	•							
TUFF BIT 369-741									•	•					
TUFF BIT 369-743									•	•					
GRADE BIT 400-022									•	•					
GRADE BIT 400-021									•	•					
GRADE BIT 368-144							•	•							
BARRACUDA BIT 369-171	•														
BARRACUDA BIT 368-891		•	•	•	•	•	•								
BARRACUDA BIT 368-890		•	•	•	•	•	•								
BARRACUDA BIT 368-894		•	•	•	•	•	•	•							
BARRACUDA BIT 368-893		•	•	•	•	•	•	•							
BARRACUDA BIT 368-892		•	•	•	•	•	•	•							
BARRACUDA BIT 369-067		•	•	•	•	•	•	•							
BARRACUDA BIT 369-181							•	•							
BARRACUDA BIT 369-468							•	•							

COMPATIBLE DITCH WITCH DRILLS

	JT520	JT920L	JT920J/921/921S	JT922	JT1220 MACH 1	JT1720 MACH 1	JT2020 MACH 1	JT2720 MACH 1	JT3020 MACH 1	JT4020 MACH 1	JT100/JT8020M1/JT7020M1	JT2720 ALL TERRAIN	JT3020 ALL TERRAIN	JT4020 ALL TERRAIN	JT100 ALL TERRAIN
BARRACUDA BIT 369-500									•	•					
BARRACUDA BIT 369-498									•	•					
BARRACUDA BIT 369-177							•								
BARRACUDA BIT 369-469		•													
BARRACUDA BIT 369-504									•	•					
BARRACUDA BIT 369-502									•	•					
BARRACUDA BIT 369-508									•	•					
BARRACUDA BIT 369-506									•	•					
HARD SURFACE BIT 369-068	•	•	•	•	•	•									
HARD SURFACE BIT 369-069	•	•	•	•	•	•	•								
HARD SURFACE BIT 369-070	•	•	•	•	•	•	•								
TORNADO BIT 400-1041	•	•	•	•	•	•									
TORNADO BIT 400-1034	•	•	•	•	•	•									
TORNADO BIT 400-1039	•	•	•	•	•	•									
TORNADO BIT 400-1057	•	•	•	•	•	•	•								
TORNADO BIT 400-1059							•	•							
TORNADO BIT 400-1061							•	•							
TORNADO BIT 400-1127									•	•					
TORNADO BIT 400-1129									•	•					
TORNADO BIT 400-1063							•	•							
STEEP TAPER BIT 369-315	•														
STEEP TAPER BIT 369-072		•	•	•	•	•									
STEEP TAPER BIT 400-160		•	•	•	•	•	•								
STEEP TAPER BIT 368-895		•	•	•	•	•	•								
STEEP TAPER BIT 400-217							•	•							
STEEP TAPER BIT 400-170							•	•							
STEEP TAPER BIT 369-074	•	•	•	•	•	•	•	•							
STEEP TAPER BIT 369-183							•	•							
STEEP TAPER BIT 369-466							•	•							
STEEP TAPER BIT 369-486									•	•					
STEEP TAPER BIT 369-179							•	•							
STEEP TAPER BIT 369-467							•	•							
STEEP TAPER BIT 369-490									•	•					
STEEP TAPER BIT 369-494									•	•					
STEEP TAPER TUFF BIT 400-120	•	•	•	•	•	•	•	•							
STEEP TAPER TUFF BIT 400-122							•	•							
STEEP TAPER TUFF BIT 400-124							•	•							
STEEP TAPER TUFF BIT 400-431									•	•					
GLACIER BIT 369-458									•						
GLACIER BIT 369-429										•					

COMPATIBLE DITCH WITCH DRILLS

	JT520	JT920L	JT920J/921/921S	JT922	JT1220 MACH 1	JT1720 MACH 1	JT2020 MACH 1	JT2720 MACH 1	JT3020 MACH 1	JT4020 MACH 1	JT100/JT8020M1	JT2720 ALL TERRAIN	JT3020 ALL TERRAIN	JT4020 ALL TERRAIN	JT100 ALL TERRAIN
RHINO ROCK BIT 400-163	•														
RHINO ROCK BIT 369-459		•	•	•											
RHINO ROCK BIT 369-511					•	•	•								
RHINO ROCK BIT 369-513								•	•						
RHINO ROCK BIT 369-989										•					
RHINO ROCK BIT 369-463											•				
COBBLE BIT 400-972									•						
SLANT FACE DUAL JET 400-1086											•	•			
SLANT FACE DUAL JET 400-1106	•	•	•	•											
SLANT FACE DUAL JET 400-1074				•	•	•									
SLANT FACE DUAL JET 400-1115							•								
SLANT FACE DUAL JET 369-112								•			•				
TALON BIT 400-1084															
TALON BIT 400-1104			•	•											
TALON BIT 400-1109				•	•	•									
TALON BIT 400-1113							•	•							
SOFT FORMATION BIT 400-971								•							
SOFT FORMATION BIT 400-1094											•	•			
SOFT FORMATION BIT 400-683											•	•		•	•
TRI-CONE BIT, MT 400-432															
TRI-CONE BIT, TCI 400-1356								•							
TRI-CONE BIT, TCI 401-345											•	•			
TRI-CONE BIT, TCI 401-349											•	•			
TRI-CONE BIT, TCI VALUE 401-138											•	•			
TRI-CONE BIT, TCI VALUE 401-139													•	•	
TRI-CONE BIT, TCI 401-346													•	•	
TRI-CONE BIT, TCI 401-347										•			•	•	
TRI-CONE BIT, TCI 401-361										•			•	•	

DITCH WITCH Beacon Housings

For hole-boring efficiency, you cannot beat Ditch Witch beacon housings. Our housings are engineered with a smaller diameter without sacrificing strength—so they're easier to push, easier to steer, and require less drilling fluid, saving time on cleanup. Our housings easily adapt to most walkover tracking systems and offer many innovative features that combine for greater overall productivity, including a straight thread pattern that provides an exceptionally strong connection, a recessed lid to reduce breakage downhole, and our industry-exclusive Beacon Buddy, which protects your electronics.

THREAD HEAD BEACON HOUSING

THREAD HEAD BEACON HOUSING'S EXCLUSIVE STRAIGHT-THREAD DESIGN GUARANTEES FULL CONTACT OF ALL THREADS AT ALL TIMES, FOR THE STRONGEST POSSIBLE CONNECTION WITH THE BIT. AND THEY'RE ENGINEERED TO TAKE A BEATING AND STILL DELIVER SMOOTH, EFFICIENT PRODUCTIVITY EVEN IN THE TOUGHEST DRILLING CONDITIONS.

PART NUMBER	STYLE	BODY	BEACON
400-1082	2.5 IN SIDELOAD	1.94-4 F/1.63-6F	86 SERIES
400-1098	2.75 IN SIDELOAD	1.94-4 F/1.88-6F	86 SERIES
400-1073	3.34 IN SIDELOAD	2.59-4 F/2.25-6F	86 SERIES
400-582	3.75 IN API SIDELOAD HIGH-FLOW	2.59-4 F/2.88-5F API	86 SERIES
400-1112	3.75 IN SIDELOAD	2.59-4 F/2.63-6F	86 SERIES
400-725	4.75 IN SIDELOAD HIGH-FLOW	3.27-4 F/3.5 F IF API	86BHL



SLANT FACE BEACON HOUSING

ENGINEERED WITH AN EXCLUSIVE WATERFLOW DESIGN, THE SLANT FACE BEACON HOUSING DIRECTS FLOW AROUND THE BEACON COMPARTMENT, EFFECTIVELY REDUCING WATER DAMAGE TO THE BEACON. THIS ECONOMICAL HOUSING ACCEPTS A VARIETY OF BITS FOR MULTIPLE DRILLING CONDITIONS, AND ITS BEACON WINDOW DESIGN PROVIDES A STRONGER BEACON SIGNAL AND LONGER BATTERY LIFE.

PART NUMBER	STYLE	BODY	BEACON
400-796	2 IN ANGLED JET SIDELOAD	1.21-6 FAPI X 3 HOLE	SBRP/88B
369-161	2 IN SLIDELOAD	1.21-6 FAPI X 3 HOLE	SBRP/88B
368-852	2.25 IN SIDELOAD	1.41-6 M/5-12	SBRP/88B
400-025	2.5 IN ENDLOAD	1.41-6 M/5-12	86 SERIES
300-1232	2.5 IN SIDELOAD	1.94-4 F/5-12 MM	86 SERIES
401-175	2.5 IN SIDELOAD	1.94-4 F/5-12 MM	SBRP/88B
400-1108	2.75 IN SIDELOAD	1.94-4 F/5-12 MM	86 SERIES
400-1172	3 IN SIDELOAD	1.94-4 F/5-12	86 SERIES
400-1065	3.34 IN SIDELOAD	2.59-4 F/6-16	86 SERIES
400-964	3.75 IN SIDELOAD	2.59-4 F/6-20	86 SERIES
368-822	4.25 IN SIDELOAD	3.27-4 F/6-20	86BHL
400-724	4.75 IN SIDELOAD HIGH-FLOW	3.27-4 F/6-20	86BHL



DITCH WITCH Beacon Housings

ALL TERRAIN BEACON HOUSING

THIS INDUSTRY-EXCLUSIVE HOUSING IS DESIGNED BY DITCH WITCH ENGINEERS TO PERFORM SPECIFICALLY WITH DITCH WITCH ALL TERRAIN DRILLS, SO YOUR RIG AND YOUR DOWNHOLE TOOLS WORK LIKE CLOCKWORK TO KEEP YOU PRODUCTIVE.

PART NUMBER	STYLE	BODY	BEACON
401-160	3.75 IN COBBLE MASTER TOOL 1.5°	2.52-4 M/2-7/8 API F	88 SERIES
401-159	3.75 IN ROCKMASTER TOOL 2°	2.77-4 AT M/2-7/8 API F	88 SERIES
401-329	3.75 IN ROCKMASTER TOOL 2°	2.77-4 AT 2-7/8 API F	850 OR 86 SERIES
400-1314	4.75 IN COBBLE MASTER TOOL 2°	2.52-4 M/2-7/8 API F	850 OR 86 SERIES
350-1254	4.75 IN ROCKMASTER TOOL 2°	2.77-4 AT M/2-7/8 API F	850 OR 86 SERIES
400-919	5 IN ROCKMASTER TOOL 1.5°	3.25-4 AT M/3.5 API F	850 OR 86 SERIES
401-241	5 IN ROCKMASTER TOOL 2°	3.25-4 AT M/3.5 API F	86 SERIES



BACKREAMER ACCESSORIES

PART NUMBER	DESCRIPTION	BODY	BEACON
400-107	3.25 IN BACKREAMER BEACON HOUSING	1.94-4 F/1.94-4F	86 SERIES
369-977	BACKREAMER TRANSITION SUB	1.94-4 M/M	



COMPATIBLE DITCH WITCH DRILLS

[illegible]

DITCH WITCH Transition Subs

Our transition subs are designed to absorb stress that would otherwise be transmitted directly to the drill pipe, beacon housings, and backreamers. Manufactured with high-strength, low-alloy steel, our transition subs are heat-treated and precision-gun-drilled to produce maximum durability. The same proprietary gauges we use on our transition subs we also use on our saver subs, drill pipe, beacon housings, backreamers and connectors, which ensures the tightest connection possible throughout the drill string, for worry-free performance downhole.

TRANSITION SUB

PART NUMBER	DESCRIPTION	MODEL(S)
369-213	1.21-6M/F API	JT520
369-326	1.41-6M/1.41-6F	JT920/JT920L/JT921/JT922
401-005	1.47-4M/1.94-4M	JT1220 MACH 1
368-985	1.69-6M/1.69-6F	JT1720 MACH 1
401-319	1.94-4M/1.94-4M	JT2020 MACH 1
400-733	2.11-4M/1.94-4F	JT2720 MACH 1
400-231	2.11-4M/2.59-4M	JT2720 MACH 1/JT3020 MACH 1
400-575	2.59-4M/2.59-4M	JT4020 MACH 1
369-222	3.27-4M/3.27-4M	JT8020 MACH 1/JT100 MACH 1



ALL TERRAIN TRANSITION SUB

PART NUMBER	DESCRIPTION	MODEL(S)
369-410	2.77-4 AT M DS/2.59-4M DS	JT2720 ALL TERRAIN/JT3020 ALL TERRAIN
400-685	3.25-4M SS/2.59-4M DS	JT4020 ALL TERRAIN/JT100 ALL TERRAIN
401-143	3.25-4M SS/3.27-4M	JT4020 ALL TERRAIN/JT100 ALL TERRAIN



ALL TERRAIN COBBLE TRANSITION SUB

PART NUMBER	DESCRIPTION	MODEL(S)
400-057	2.52-4M SS/2.59-4M DS	JT2720 ALL TERRAIN/JT3020 ALL TERRAIN



DITCH WITCH Saver Subs

Ditch Witch saver subs are designed and manufactured to provide superior protection against wear and tear on the drill pipe and drive system. Made of high-grade steel, these solid, one-piece units are engineered with the same proprietary gauges used on all Ditch Witch drill string components, so you won't find a saver sub that provides a tighter connection or does more to maximize the overall integrity of the drill string.

SAVER SUB

PART NUMBER	MODEL(S)
302-643	JT520
301-891	JT920/JT920L/JT921/JT921S
300-2340	JT922
400-604	JT1220
301-892	JT1720 MACH 1
400-905	JT2020 MACH 1
400-1224	JT2720 MACH 1
400-1226	JT2720 ALL TERRAIN
400-1225	JT2720 ALL TERRAIN COBBLE
400-1223	JT3020 MACH 1
400-1222	JT3020 ALL TERRAIN
400-1221	JT3020 ALL TERRAIN COBBLE
400-1134	JT4020 MACH 1
400-1135	JT4020 ALL TERRAIN/JT100 ALL TERRAIN
400-1132	JT8020 MACH 1/JT100 MACH 1



DITCH WITCH EZ Connects

The EZ Connect is a time- and energy-saving innovation developed by Ditch Witch engineers to help you easily and quickly remove the drill head or backreamer without the need for heavy tools. With the Ditch Witch EZ Connect in place, you simply remove one small bolt, slide a collar, and unscrew the drill head or backreamer by hand. EZ Connects are precision-milled for reliable performance and feature long-lasting, heat-treated steel collars that are sized to match the diameter of the housing, so spoils removal is far more efficient.

EZ CONNECT ASSEMBLY

PART NUMBER	DESCRIPTION	MODEL(S)
368-816	EZ CONNECT ASSEMBLY	JT8020 MACH 1/JT100 MACH 1
368-814	EZ CONNECT PIN	
368-815	COLLAR	
105-593	RETAINER BOLT	
368-813	EZ CON BOX	



EZ CONNECT 2 ASSEMBLY

PART NUMBER	DESCRIPTION	MODEL(S)
400-105	EZ CONNECT 2 ASSEMBLY	JT520
400-104	EZ CONNECT TRANSITION SUB	
149-104	O-RING	
369-258	COLLAR	
107-519	RETAINER BOLT	

PART NUMBER	DESCRIPTION	MODEL(S)
400-070	EZ CONNECT 2 ASSEMBLY	JT920/JT920L/JT921/JT922
400-067	EZ CONNECT TRANSITION SUB	
149-911	O-RING	
400-069	COLLAR	
107-540	RETAINER BOLT	

PART NUMBER	DESCRIPTION	MODEL(S)
400-001	EZ CONNECT 2 ASSEMBLY	JT1720 MACH 1
369-998	EZ CONNECT TRANSITION SUB	
157-194	O-RING	
369-154	COLLAR	
107-521	RETAINER BOLT	

PART NUMBER	DESCRIPTION	MODEL(S)
401-300	EZ CONNECT 2 ASSEMBLY	JT2020 MACH 1
401-301	EZ CONNECT PIN	
157-194	O-RING	
369-154	COLLAR	
107-521	RETAINER BOLT	

PART NUMBER	DESCRIPTION	MODEL(S)
400-1067	EZ CONNECT 2 ASSEMBLY	JT2720 ALL TERRAIN/JT3020 ALL TERRAIN
400-1055	EZ CONNECT TRANSITION SUB	
149-041	O-RING	
400-093	COLLAR	
107-513	RETAINER BOLT	
316-573	INNER ROCK SUPPORT BLOCK	



EZ CONNECT 2 ASSEMBLY

PART NUMBER	DESCRIPTION	MODEL(S)
369-814	EZ CONNECT 2 ASSEMBLY	JT2720 MACH 1
369-812	EZ CONNECT TRANSITION SUB	
149-548	O-RING	
369-811	COLLAR	
107-521	RETAINER BOLT	
PART NUMBER	DESCRIPTION	MODEL(S)
400-731	EZ CONNECT 2 ASSEMBLY	JT2720 MACH 1
400-732	EZ CONNECT TRANSITION SUB	
157-194	O-RING	
369-154	COLLAR	
107-521	RETAINER BOLT	
PART NUMBER	DESCRIPTION	MODEL(S)
400-1049	EZ CONNECT 2 ASSEMBLY	JT3020 MACH 1
400-1030	EZ CONNECT TRANSITION SUB	
149-548	O-RING	
400-1019	COLLAR	
106-847	RETAINER BOLT	
PART NUMBER	DESCRIPTION	MODEL(S)
400-095	EZ CONNECT 2 ASSEMBLY	JT4020 MACH 1
400-096	EZ CONNECT TRANSITION SUB	
149-041	O-RING	
400-093	COLLAR	
107-513	RETAINER BOLT	



EZ CONNECT 3 ASSEMBLY

PART NUMBER	DESCRIPTION	MODEL(S)
400-1142	EZ CONNECT 3 ASSEMBLY	JT2720 ALL TERRAIN/JT3020 ALL TERRAIN
400-1141	EZ CONNECT TRANSITION SUB	
149-548	O-RING	
400-1019	COLLAR	
106-847	RETAINER BOLT	
316-573	INNER ROCK SUPPORT BLOCK	
PART NUMBER	DESCRIPTION	MODEL(S)
400-918	EZ CONNECT 3 ASSEMBLY	JT1220 MACH 1
400-917	EZ CONNECT TRANSITION SUB	
153-856	O-RING	
400-926	COLLAR	
106-847	RETAINER BOLT	



DITCH WITCH Connectors

Connectors are versatile components designed to connect any Ditch Witch beacon housing or backreamer to fit your machine. Manufactured from high-alloy steel to exacting tolerances, Ditch Witch connectors are the tools you need to establish solid pin-to-pin, pin-to-box, backreamer-to-drill pipe, and other connections, and also prevent wear on the components they are connecting. We offer the widest range of connectors available to adapt to virtually any drilling situation. We can also customize connectors to your specifications.

ALL TERRAIN CENTERING CONE CONNECTOR

PART NUMBER	DESCRIPTION	MODEL(S)
401-273	2.59-4F DS/2.77-4F DS	JT2720 ALL TERRAIN/JT3020 ALL TERRAIN
401-272	2.77-M DS/2.59-4M DS	JT2720 ALL TERRAIN/JT3020 ALL TERRAIN
401-274	2.59-4M/3.25-4AT M	JT4020 ALL TERRAIN/JT100 ALL TERRAIN
401-275	2.59-4F DS/3.25-4F SS	JT4020 ALL TERRAIN/JT100 ALL TERRAIN



CONNECTOR

PART NUMBER	DESCRIPTION	MODEL(S)
369-470	1.21-6M/1.21-6M	JT520
369-310	1.21-6M API/1.41-6F API	JT520
369-306	1.21-6M API/1.94-4M API	JT520
369-257	1.31-6F EZ2/1.21-6M API	JT520
369-311	1.31-6F EZ2/1.41-6F	JT520
369-307	1.31-6F EZ2/1.94-4M	JT520
368-263	1.41-6M/1.94-4M	JT920/JT920L/JT921/JT922
400-064	1.63-6F EZ2/1.41-6F	JT920/JT920L/JT921/JT922
400-068	1.63-6F EZ2/1.94-4M	JT920/JT920L/JT921/JT922
401-006	1.88-6F EZ 3/1.94-4F	JT1220 MACH 1
400-920	1.88-6F EZ3/1.94-4M	JT1220 MACH 1
368-261	1.94-4M/1.94-4M	JT1220 MACH 1
368-264	1.69-6M/1.94-4M	JT1720 MACH 1
369-565	2-6F EZ2/1.69-6F	JT1720 MACH 1/JT2020 MACH 1
400-615	2-6F EZ2/1.94-4F	JT1720 MACH 1/JT2020 MACH 1
369-999	2-6F EZ2/1.94-4M	JT1720 MACH 1/JT2020 MACH 1
400-136	2-6F EZ2/2.4-4M	JT1720 MACH 1
400-824	2-6F EZ2/2.59-4M	JT2020 MACH 1
369-139	1.94-4M/2.52-4M	JT2720 MACH 1
401-340	2.25-6F EZ2/2.4-4M	JT2720 MACH 1
400-309	2.25-6F EZ2/2.59-4M	JT2720 MACH 1
400-1010	2.25-6F EZ3/2.59-4M	JT3020 MACH 1
400-576	2.59-4F X 3.27-4M	JT3020 MACH 1/JT4020 MACH 1



CONNECTOR

PART NUMBER	DESCRIPTION	MODEL(S)
400-094	2.36-6F EZ2/2.59-4M	JT4020 MACH 1
400-091	2.63-6F EZ2/3.27-4M	JT4020 MACH 1
400-041	2.88-5M API/2.38 M API	JT4020 MACH 1
400-038	2.88-5M API/2.38 M IF	JT4020 MACH 1
400-016	2.88-5M API/2.88-5 M IF	JT4020 MACH 1
400-040	2.88-5M API/3.5 M API	JT4020 MACH 1
400-039	2.88-5M API M/M API	JT4020 MACH 1
401-255	3.27-4F/2.88 API IF M	JT8020 MACH 1/JT100 MACH 1/JT4020 ALL TERRAIN
401-256	3.27-4F/3.5 API REG M	JT8020 MACH 1/JT100 MACH 1/JT4020 ALL TERRAIN
369-089	3.27-4M/3.50 API REG M	JT8020 MACH 1/JT100 MACH 1
368-742	3.27-4M/M	JT8020 MACH 1/JT100 MACH 1
400-035	3.5 IF M/3.5 IF M	JT8020 MACH 1/JT100 MACH 1
400-036	3.5 IF M/3.5 REG M	JT8020 MACH 1/JT100 MACH 1
400-567	2.59-4F/2.40-4M	JT2720 ALL TERRAIN/JT3020 ALL TERRAIN
400-576	2.59-4F/3.27-4M	JT2720 ALL TERRAIN/JT3020 ALL TERRAIN
400-568	2.59-4F/3.50 REG F	JT2720 ALL TERRAIN/JT3020 ALL TERRAIN/JT4020 ALL TERRAIN



DITCH WITCH Drill Pipe

The patented Ditch Witch manufacturing process produces the straightest, strongest pipe in the business. Power Pipe® is a high-strength, low-alloy steel pipe that provides the perfect balance of tensile strength and flexibility for horizontal directional drilling. It is available with our patented Fluid Miser® II lining, which reduces drilling fluid volume of the pipe by as much as 66 percent, allowing the drill string to pressure up faster and clean up quicker. The All Terrain's patented shaft-within-a-pipe design enables the drilling rig to transfer power to the cutting head more efficiently than any other steerable rock-drilling system. And UFE pipe is composed of forged tubing and high-strength alloy ends designed by Ditch Witch engineers specifically for the unit.

POWER PIPE®, UNLINED

MANUFACTURED EXCLUSIVELY BY THE CHARLES MACHINE WORKS, INC., DITCH WITCH POWER PIPE® IS A HIGH-STRENGTH, LOW-ALLOY STEEL PIPE THAT PROVIDES MAXIMUM TENSILE STRENGTH. OUR PATENTED MANUFACTURING PROCESS PRODUCES THE STRAIGHTEST PIPE IN THE BUSINESS. ITS EXPANDED, EXCEPTIONALLY STRONG ENDS ARE FORMED WITHOUT THE HEAT OF THE FORGING PROCESS, LEAVING THE INTEGRITY OF THE PIPE INTACT AND NO STRENGTH REDUCTION AT THE HEAT-AFFECTED ZONES.

PART NUMBER	MODEL(S)	OD TOOL JOINT X OD PIPE BODY	DRILL PIPE LENGTH	BEND RADIUS
400-842	JT920L	2 IN X 1.63 IN	116 IN/3 M	100 FT/30.5 M
400-963	JT921	2 IN X 1.58 IN	78 IN/2 M	105 FT/32 M
400-1118	JT922	2 IN X 1.58 IN	72 IN/1.8 M	105 FT/32 M
355-1005	JT1220 MACH 1	2.38 IN X 1.82 IN	120 IN/3 M	105 FT/32 M
400-843	JT1720 MACH 1	2.5 IN X 2.06 IN	120 IN/3 M	130 FT/39.6 M
401-339	JT2020 MACH 1	2.63 IN X 2.06 IN	120 IN/3 M	130 FT/39.6 M
400-1031	JT3020 MACH 1	3 IN X 2.38 IN	120 IN/3 M	174 FT/53 M
	JT2720 MACH 1			
400-847	JT4020 MACH 1	3.5 IN X 2.81 IN	177 IN/4.5 M	190 FT/58 M



POWER PIPE®, LINED, FLUID MISER® II

DITCH WITCH POWER PIPE® IS ALSO AVAILABLE WITH EXCLUSIVE FLUID MISER® II LINING. WITH PATENTED FLUID MISER II INSIDE EACH JOINT OF PIPE, DRILLING FLUID VOLUME IS REDUCED BY AS MUCH AS 66 PERCENT, ALLOWING THE DRILL STRING TO PRESSURE UP FASTER AND CLEAN UP QUICKER, WHICH SAVES YOU TIME AND MONEY. THE FLUID MISER II LINING ALSO MINIMIZES INTERNAL RUST AND REDUCES SPILLAGE DURING PIPE BREAKOUT.

PART NUMBER	MODEL(S)	OD TOOL JOINT X OD PIPE BODY	DRILL PIPE LENGTH	BEND RADIUS
369-227	JT920L	2 IN X 1.63 IN	116 IN/3 M	100 FT/30.5 M
369-048	JT921	2 IN X 1.58 IN	78 IN/2 M	105 FT/32 M
355-269	JT922	2 IN X 1.58 IN	72 IN/1.8 M	105 FT/32 M
401-239	JT1220 MACH 1	2.38 IN X 1.82 IN	120 IN/3 M	105 FT/32 M
369-056	JT1720 MACH 1	2.5 IN X 2.06 IN	120 IN/3 M	130 FT/39.6 M
401-304	JT2020 MACH 1	2.63 IN X 2.06 IN	120 IN/3 M	130 FT/39.6 M
400-1029	JT3020 MACH 1	3 IN X 2.38 IN	120 IN/3 M	174 FT/53 M
	JT2720 MACH 1			
369-804	JT4020 MACH 1	3.5 IN X 2.81 IN	177 IN/4.5 M	190 FT/58 M



NOTE: SEE YOUR LOCAL DITCH WITCH DEALER FOR PIPE COMPATIBLE WITH EARLIER MODELS.

ALL TERRAIN PIPE

THE PATENTED SHAFT-WITHIN-A-PIPE DESIGN OF OUR ALL TERRAIN SYSTEMS FEATURES A STRONG DRIVE ROD THAT TURNS INSIDE AN OUTER PIPE. THIS ENABLES ALL TERRAIN SYSTEMS TO TRANSFER POWER TO THE CUTTING HEAD MORE EFFICIENTLY THAN ANY OTHER SYSTEM—AND OUTPERFORM ALL OTHER ROCK SYSTEMS IN THEIR HORSEPOWER CLASS.

PART NUMBER	MODEL(S)	DESCRIPTION	DRILL PIPE LENGTH	BEND RADIUS
369-448	JT3020 ALL TERRAIN JT2720 ALL TERRAIN	POWER PIPE ASSEMBLY AT	112 IN/2.84 M	174 FT/53 M
369-717	JT3020 ALL TERRAIN JT2720 ALL TERRAIN	LEAD PIPE ASSEMBLY 4.75 AT	112 IN/2.84 M	174 FT/53 M
400-658	JT3020 ALL TERRAIN JT2720 ALL TERRAIN	POWER PIPE ASSEMBLY AT COBBLE	112 IN/2.84 M	210 FT/64 M
400-659	JT3020 ALL TERRAIN JT2720 ALL TERRAIN	LEAD PIPE ASSEMBLY 4.75 AT COBBLE	112 IN/2.84 M	210 FT/64 M
355-1041	JT4020 ALL TERRAIN	UFE PIPE ASSEMBLY	171 IN/4.34 M	299 FT/91 M



UFE PIPE

DITCH WITCH UFE (UPSET FORGED END) PIPE IS A COMPOSITE DESIGN WITH TUBING AND HIGH-STRENGTH ALLOY ENDS, MAKING THE PIPE AND TOOL JOINTS STRONGER AND MORE RESISTANT TO ABRASION. AFTER FORGING, ALL DITCH WITCH UFE PIPES ARE FULLY HEAT-TREATED TO ELIMINATE ANY POTENTIAL HEAT-AFFECTED ZONES.

PART NUMBER	MODEL(S)	OD TOOL JOINT X OD PIPE BODY	DRILL PIPE LENGTH	BEND RADIUS
369-318	JT520	1.75 IN X 1.13 IN	59.1 INCHES/ 1.5 METER	70 FEET/ 21.3 M
368-665	JT100 MACH 1 JT8020 MACH 1 JT7020 MACH 1	4 IN X 3.63 IN	177 INCHES/ 4.5 METER	230 FEET/ 70 M



WHY FLUID MISER® II LINED PIPE?

THE DITCH WITCH ORGANIZATION IS THE ONLY HDD MANUFACTURER THAT DESIGNS, TESTS, AND BUILDS ITS OWN PIPE TO MATCH THE SPECIFICATIONS OF THE RIG. YOU CAN ONLY PURCHASE FLUID MISER II LINED PIPE FROM YOUR AUTHORIZED DITCH WITCH DEALER.

FIVE REASONS TO USE FLUID MISER® II LINED PIPE

1. USES UP TO 76% LESS FLUID
2. PRESSURES UP QUICKER
3. LESS CLEANUP
4. REDUCES RUST SCALING INSIDE PIPE THAT COULD PLUG NOZZLES
5. LESS WEAR ON THE FLUID PUMPS



DITCH WITCH Quick Wrenches & Jaws

These patented wrenches are designed and tested exclusively for Ditch Witch downhole tools. Ditch Witch quick wrenches and jaws provide an effective way to manually connect and disconnect portions of the drill string. Use them to help you disconnect the drill head from the drill string before attaching a backreamer, or to connect the drill head to the drill string before drilling. We offer a variety of jaw shapes and sizes to accommodate the installation or removal of different types of bits, backreamers and transition subs.

HYDRA-TONG

PART NUMBER
400-856



WRENCH SET

PART NUMBER
369-297
401-229
368-761
401-1001



FLAT JAW

PART NUMBER	SIZE
368-693	1.24 IN
369-281	1.42 IN
369-282	1.56 IN
368-692	1.63 IN
368-691	1.88 IN
368-690	2 IN
368-689	2.1 IN
368-688	2.25 IN
359-103	2.25 IN
368-687	2.35 IN
368-686	2.4 IN
369-286	2.5 IN
400-004	3.25 IN
368-682	3.75 IN
400-749	4.5 IN



DITCH WITCH Quick Wrenches & Jaws

TALON JAW

PART NUMBER	SIZE
400-1154	4 IN
400-1153	4.5 IN
400-1122	5.5 IN
400-1139	6 IN



SOFT FORMATION JAW

PART NUMBER	SIZE
401-148	6.25 IN
400-1119	6.65 IN

TRI-CONE JAW

PART NUMBER	SIZE
369-795	4.75 IN
400-744	4.75 IN
400-928	5.5 IN
400-734	6.25 IN
401-133	6.25 IN
400-705	6.5 IN

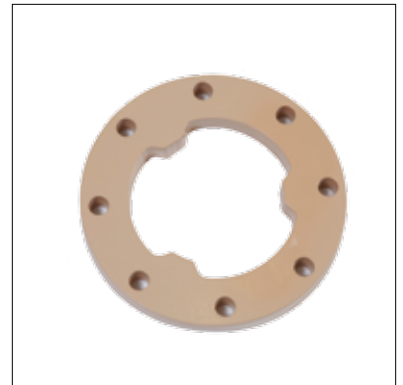

DITCH WITCH Quick Wrenches & Jaws

COMPATIBLE DITCH WITCH DRILLS

	JT520	JT920L	JT920J/921/921S	JT922	JT1220 MACH 1	JT1720 MACH 1	JT2020 MACH 1	JT2720 MACH 1	JT3020 MACH 1	JT4020 MACH 1	JT100/JT8020M1	JT2720 ALL TERRAIN	JT3020 ALL TERRAIN	JT4020 ALL TERRAIN	JT100 ALL TERRAIN
HYDRA-TONG 400-856									•	•			•	•	
WRENCH SET 369-297	•	•	•		•										
WRENCH SET 401-229			•	•		•									
WRENCH SET 368-761							•	•				•	•		
WRENCH SET 401-1001													•	•	
FLAT JAW 368-693	•	•	•	•											
FLAT JAW 369-281	•														
FLAT JAW 369-282	•														
FLAT JAW 368-692	•	•	•	•			•								
FLAT JAW 368-691		•	•	•			•								
FLAT JAW 368-690		•	•	•	•	•	•								
FLAT JAW 368-689				•	•	•	•								
FLAT JAW 368-688		•	•	•											
FLAT JAW 359-103	•			•	•	•									
FLAT JAW 368-687		•	•	•	•	•	•				•	•			
FLAT JAW 368-686				•	•	•	•								
FLAT JAW 369-286					•	•									
FLAT JAW 400-004											•	•			
FLAT JAW 368-682											•	•			
FLAT JAW 400-749													•	•	
TALON JAW 400-1154		•		•	•										
TALON JAW 400-1153						•									
TALON JAW 400-1122							•	•							
TALON JAW 400-1139									•						
SOFT FORMATION JAW 401-148													•	•	
SOFT FORMATION JAW 400-1119											•	•			
TRI-CONE JAW 369-795											•	•			
TRI-CONE JAW 400-744									•						
TRI-CONE JAW 400-928											•	•			
TRI-CONE JAW 400-734													•	•	
TRI-CONE JAW 401-133													•	•	
TRI-CONE JAW 400-705						•				•			•	•	

DITCH WITCH Backreamers

Often imitated but never duplicated, Ditch Witch backreamers are the longest-lasting, most ruggedly built in the directional drilling industry. We manufacture and exhaustively test each backreamer for both the soil conditions it is suited for and the drill it is designed to work with, so you can be sure that the combination of your Ditch Witch drill and backreamer is providing superior performance. From the cutting and expanding requirements of extreme soil conditions like rock, chunk rock, and cobble, to the challenge of managing the spoils of long bores, Ditch Witch backreamers are engineered to be the most flexible in the industry.

CAST FLUTED BACKREAMER

DESIGNED FOR CUTTING AND COMPACTING THE HOLE IN MEDIUM TO TOUGH SOIL CONDITIONS, THE CAST FLUTED BACKREAMER IS MANUFACTURED TO BE STRONG, DURABLE, LIGHTER IN WEIGHT AND MORE ECONOMICAL THAN SOLID STEEL. FEATURES A BUILT-IN SWIVEL AND CARBIDE-FACED SHARK TOOTH CUTTERS FOR MAXIMUM PRODUCTIVITY AND DURABILITY. FLUID PORTS ARE POSITIONED FOR EFFICIENT FLUID MIXING AND FOR LUBRICATION OF THE HOLE, TOOL AND THE PRODUCT BEING INSTALLED.

PART NUMBER	CUT	DESCRIPTION	SHAFT	ENDS	NOZZLE THREAD
400-269	8 IN	20K SWIVEL	3.5 IN	2.59-4 F/SWIVEL	ROLL PINS
400-270	10 IN	30K SWIVEL	3.5 IN	2.59-4 F/SWIVEL	ROLL PINS
400-271	12 IN	40K SWIVEL	3.5 IN	2.59-4 F/SWIVEL	ROLL PINS
400-272	14 IN	40K SWIVEL	3.5 IN	2.59-4 F/SWIVEL	ROLL PINS
400-273	16 IN	40K SWIVEL	3.5 IN	2.59-4 F/SWIVEL	ROLL PINS
400-274	18 IN	40K SWIVEL	3.5 IN	2.59-4 F/SWIVEL	ROLL PINS
400-482	8 IN	40K SWIVEL	4 IN	3.27-4 F/70K SWIVEL	ROLL PINS
400-481	10 IN	40K SWIVEL	4 IN	3.27-4 F/70K SWIVEL	ROLL PINS
400-495	12 IN	40K SWIVEL	4 IN	3.27-4 F/70K SWIVEL	ROLL PINS
400-496	14 IN		4 IN	3.27-4 F/70K SWIVEL	ROLL PINS
400-497	16 IN		4 IN	3.27-4 F/70K SWIVEL	ROLL PINS
400-498	18 IN		4 IN	3.27-4 F/70K SWIVEL	ROLL PINS
400-275	20 IN		4 IN	3.27-4 F/70K SWIVEL	ROLL PINS
400-276	22 IN		4 IN	3.27-4 F/70K SWIVEL	ROLL PINS
400-277	24 IN		4 IN	3.27-4 F/70K SWIVEL	ROLL PINS
400-278	28 IN		4 IN	3.27-4 F/70K SWIVEL	ROLL PINS



COMPACT FLUTED BACKREAMER

FEATURING A BUILT-IN SWIVEL, THE COMPACT FLUTED BACKREAMER IS USED FOR CUTTING AND COMPACTING THE HOLE IN MEDIUM TO TOUGH SOIL CONDITIONS. NOZZLES OVER THE ENTIRE BODY PROVIDE GOOD MIXING ACTION AND EFFICIENT LUBRICATION IN THE SOIL.

PART NUMBER	CUT	ENDS	NOZZLE THREAD
357-696	4.5 IN	1.41-6 M/20K TAB	7/16-20
401-355	4.5 IN	1.94-4 F/20K TAB	7/16-20
368-942	6.5 IN	1.94-4 F/20K TAB	7/16-20
368-944	8.5 IN	1.94-4 F/20K TAB	7/16-20
368-946	10.5 IN	1.94-4 F/30K TAB	7/16-20



DITCH WITCH Backreamers

BEAVERTAIL BACKREAMER

A LOW-WEIGHT DESIGN AND LOW-RESISTANCE PROFILE GIVE THE PATENTED BEAVERTAIL BACKREAMER EFFICIENT FLUID-MIXING CAPABILITY, REQUIRING FAR LESS HORSEPOWER FOR ROTATION IN A VARIETY OF SOIL CONDITIONS.

PART NUMBER	CUT	SHAFT	ENDS	NOZZLE THREAD
369-198	4.5 IN	2 IN	1.41-6 M/12K TAB	7/16-20
368-536	6 IN	2 IN	1.41-6 M/12K TAB	7/16-20
368-539	8 IN	2 IN	1.41-6 M/12K TAB	7/16-20
368-542	10 IN	2 IN	1.41-6 M/12K TAB	7/16-20
368-545	12 IN	2 IN	1.41-6 M/12K TAB	7/16-20
368-548	14 IN	2 IN	1.41-6 M/12K TAB	7/16-20
369-201	6 IN	2.75 IN	1.94-4 F/30K TAB	7/8-14
368-419	8 IN	2.75 IN	1.94-4 F/30K TAB	7/8-14
368-424	10 IN	2.75 IN	1.94-4 F/30K TAB	7/8-14
368-621	12 IN	2.75 IN	1.94-4 F/30K TAB	7/8-14
368-427	14 IN	2.75 IN	1.94-4 F/30K TAB	7/8-14
368-430	18 IN	2.75 IN	1.94-4 F/30K TAB	7/8-14
368-433	22 IN	2.75 IN	1.94-4 F/30K TAB	7/8-14
400-323	8 IN	3.5 IN	2.59-4 F/40K SOC	7/16-20
400-324	10 IN	3.5 IN	2.59-4 F/40K SOC	7/16-20
400-325	12 IN	3.5 IN	2.59-4 F/40K SOC	7/16-20
400-326	14 IN	3.5 IN	2.59-4 F/40K SOC	7/16-20
400-327	16 IN	3.5 IN	2.59-4 F/40K SOC	7/16-20
400-328	18 IN	3.5 IN	2.59-4 F/40K SOC	7/16-20
400-1339	12 IN	4.25 IN	3.27-4 F/70K TAB	7/8-14
400-1338	14 IN	4.25 IN	3.27-4 F/70K TAB	7/8-14
400-1337	18 IN	4.25 IN	3.27-4 F/70K TAB	7/8-14
400-1336	22 IN	4.25 IN	3.27-4 F/70K TAB	7/8-14
400-1335	26 IN	4.25 IN	3.27-4 F/70K TAB	7/8-14
400-1334	30 IN	4.25 IN	3.27-4 F/70K TAB	7/8-14
400-1322	36 IN	4.25 IN	3.27-4 F/70K TAB	7/8-14



WATER WING BACKREAMER

OUTER RING ADDS STRENGTH AND STABILITY AS THE BACKREAMER EXPANDS THE HOLE. FLUID IS DELIVERED AT THE CUTTING EDGE, WHICH KEEPS THE CUTTINGS FLOWING OUT INSTEAD OF BALLING UP ON THE REAMER.

PART NUMBER	CUT	SHAFT	ENDS	NOZZLE THREAD
369-782	12 IN	2.75 IN	1.94-4 F/30K TAB	7/16-20
369-783	16 IN	2.75 IN	1.94-4 F/30K TAB	7/16-20
369-784	20 IN	2.75 IN	1.94-4 F/30K TAB	7/16-20
369-785	24 IN	2.75 IN	1.94-4 F/30K TAB	7/16-20
400-205	8 IN	3.5 IN	2.59-4 F/40K SOC	N/A
400-206	10 IN	3.5 IN	2.59-4 F/40K SOC	N/A
400-186	12 IN	3.5 IN	2.59-4 F/40K SOC	N/A
400-187	14 IN	3.5 IN	2.59-4 F/40K SOC	N/A
400-188	16 IN	3.5 IN	2.59-4 F/40K SOC	N/A
400-189	18 IN	3.5 IN	2.59-4 F/40K SOC	N/A
369-236	12 IN	4 IN	3.27-4 F/70K TAB	7/16-20
369-237	16 IN	4 IN	3.27-4 F/70K TAB	7/16-20
369-238	20 IN	4 IN	3.27-4 F/70K TAB	7/16-20
369-239	24 IN	4 IN	3.27-4 F/70K TAB	7/16-20
369-240	28 IN	4 IN	3.27-4 F/70K TAB	7/16-20
369-241	32 IN	4 IN	3.27-4 F/70K TAB	7/16-20



THREE WING ROCK BACKREAMER

DESIGNED FOR LOW TORQUE PRESSURES AND EXCELLENT FLUID MIXING AND FLOW, THE THREE WING ROCK BACKREAMER FEATURES CARBIDE-REINFORCED SHARK TEETH STRATEGICALLY POSITIONED TO BACKREAM IN EXTREME SOIL CONDITIONS SUCH AS HARD, COMPACTED SOILS, SANDSTONE AND SOFTER LIMESTONES.

PART NUMBER	CUT	SHAFT	ENDS	NOZZLE THREAD
369-587	8 IN	3 IN	1.94-4 F/30K TAB	7/16-20
369-588	10 IN	3 IN	1.94-4 F/30K TAB	7/16-20
369-589	12 IN	3 IN	1.94-4 F/30K TAB	7/16-20
369-590	14 IN	3 IN	1.94-4 F/30K TAB	7/16-20
369-591	18 IN	3 IN	1.94-4 F/30K TAB	7/16-20
369-592	22 IN	3 IN	1.94-4 F/30K TAB	7/16-20
369-593	26 IN	3 IN	1.94-4 F/30K TAB	7/16-20
400-355	8 IN	3.5 IN	2.59-4 F/40K SOC	N/A
400-356	10 IN	3.5 IN	2.59-4 F/40K SOC	N/A
400-357	12 IN	3.5 IN	2.59-4 F/40K SOC	N/A
400-358	14 IN	3.5 IN	2.59-4 F/40K SOC	N/A
400-359	16 IN	3.5 IN	2.59-4 F/40K SOC	N/A
400-360	18 IN	3.5 IN	2.59-4 F/40K SOC	N/A
369-548	12 IN	4 IN	3.27-4 F/70K TAB	7/16-20
369-549	14 IN	4 IN	3.27-4 F/70K TAB	7/16-20
369-550	18 IN	4 IN	3.27-4 F/70K TAB	7/16-20
369-551	22 IN	4 IN	3.27-4 F/70K TAB	7/16-20
369-552	26 IN	4 IN	3.27-4 F/70K TAB	7/16-20
369-553	30 IN	4 IN	3.27-4 F/70K TAB	7/16-20
369-554	36 IN	4 IN	3.27-4 F/70K TAB	7/16-20



KODIAK COBBLE BACKREAMER

DESIGNED FOR EXTREME SOIL CONDITIONS—SUCH AS ROCK, CHUNK ROCK, AND COBBLE—WHERE A PADDLE-TYPE REAMER COULD NOT SURVIVE, THE KODIAK COBBLE BACKREAMER'S SPIRALING FLUTES PROVIDE A CUTTING SURFACE THAT ALLOWS CUTTINGS AND FLUID TO FLOW BEHIND THE REAMER AND OVER THE PRODUCT.

PART NUMBER	CUT	SHAFT	ENDS	NOZZLE THREAD
369-660	8 IN	3 IN	1.94-4 F/30K TAB	7/16-20
369-661	10 IN	3 IN	1.94-4 F/30K TAB	7/16-20
369-662	12 IN	3 IN	1.94-4 F/30K TAB	7/16-20
369-663	16 IN	3 IN	1.94-4 F/30K TAB	7/16-20
369-664	20 IN	3 IN	1.94-4 F/30K TAB	7/16-20
400-329	8 IN	3.5 IN	2.59-4 F/40K SOC	7/16-20
400-330	10 IN	3.5 IN	2.59-4 F/40K SOC	N/A
400-331	12 IN	3.5 IN	2.59-4 F/40K SOC	N/A
400-332	14 IN	3.5 IN	2.59-4 F/40K SOC	N/A
400-333	16 IN	3.5 IN	2.59-4 F/40K SOC	N/A
400-334	18 IN	3.5 IN	2.59-4 F/40K SOC	N/A
369-667	10 IN	4 IN	3.27-4 F/70K TAB	7/16-20
369-668	12 IN	4 IN	3.27-4 F/70K TAB	7/16-20
369-669	16 IN	4 IN	3.27-4 F/70K TAB	7/16-20
400-1213	20 IN	4.75 IN	3.27-4 F/70K TAB	7/16-20
400-1214	24 IN	4.75 IN	3.27-4 F/70K TAB	7/16-20
400-1215	28 IN	4.75 IN	3.27-4 F/70K TAB	7/16-20
400-1216	32 IN	4.75 IN	3.27-4 F/70K TAB	7/16-20
400-1217	36 IN	4.75 IN	3.27-4 F/70K TAB	7/16-20



DITCH WITCH Backreamers

ROCKMASTER BACKREAMER

DESIGNED FOR HEAVY OR SOLID ROCK BORES, THE ROCKMASTER IS AVAILABLE IN FOUR REAMER BODY SIZES. FEATURES INCLUDE REPLACEABLE MILL TOOTH OR TCI (TUNGSTEN CARBIDE INSERT) CUTTERS THAT ARE FIELD-REPLACEABLE AND GAUGE-PROTECTED FOR EXTENDED LIFE. HOLE DIAMETERS RANGE FROM 6 IN (152 MM) TO 22 IN (559 MM), DEPENDING ON THE REAMER BODY AND CUTTERS USED.

PART NUMBER	CUT	DESCRIPTION	SHAFT	ENDS
190-1403	6 IN	TCI	2.75 IN	2.59-4 F/30K TAB
190-1404	6 IN	MT	2.75 IN	2.59-4 F/30K TAB
190-1391	8 IN	TCI	4 IN	2.59-4 F/40K SOC
190-1392	8 IN	MT	4 IN	2.59-4 F/40K SOC
190-1393	10 IN	TCI	4 IN	2.59-4 F/40K SOC
190-1394	10 IN	MT	4 IN	2.59-4 F/40K SOC
190-1395	12 IN	TCI	4 IN	2.59-4 F/40K SOC
190-1396	12 IN	MT	4 IN	2.59-4 F/40K SOC
190-1397	10 IN	TCI	5.75 IN	3.5 IN API M/30K TAB
190-1398	10 IN	MT	5.75 IN	3.5 IN API M/30K TAB
190-1399	12 IN	TCI	5.75 IN	3.5 IN API M/30K TAB
190-1400	12 IN	MT	5.75 IN	3.5 IN API M/30K TAB
190-1401	14 IN	TCI	5.75 IN	3.5 IN API M/30K TAB
190-1402	14 IN	MT	5.75 IN	3.5 IN API M/30K TAB
190-1405	16 IN	TCI 500 SERIES	8 IN	3.27-4 FM/70K TAB
190-1406	16 IN	TCI 700 SERIES	8 IN	3.27-4 FM/70K TAB
190-1407	18 IN	TCI 500 SERIES	8 IN	3.27-4 FM/70K TAB
190-1408	18 IN	TCI 700 SERIES	8 IN	3.27-4 FM/70K TAB
190-1409	20 IN	TCI 500 SERIES	8 IN	3.27-4 FM/70K TAB
190-1410	20 IN	TCI 700 SERIES	8 IN	3.27-4 FM/70K TAB
190-1411	22 IN	TCI 500 SERIES	8 IN	3.27-4 FM/70K TAB
190-1412	22 IN	TCI 700 SERIES	8 IN	3.27-4 FM/70K TAB

NOTE: ASK YOUR LOCAL DITCH WITCH DEALER ABOUT REPLACEMENT CONES.



PRE CUTTER

THE PRE CUTTER IS USED IN A VARIETY OF SOIL CONDITIONS IN PLACE OF OR IN FRONT OF THE BACKREAMER TO CLEAN AND/OR ENLARGE THE BORE HOLE.

PART NUMBER	ENDS	NOZZLE THREAD
368-354	1.41-6 M/1.41-6 F	7/16-20
401-008	1.94-4 M/1.94-4 F	7/16-20
400-614	2.59-4 F/2.59-4 M	7/16-20
400-102	2.63-6 F EZ2/3.27-4 M	7/16-20



DITCH WITCH Backreamers

SOIL CONDITION CHART

Key ● =Best ◐ =Better ○ =Good

THIS CHART HELPS YOU CHOOSE THE IDEAL BACKREAMER FOR A PARTICULAR TYPE OF SOIL.

	Sandy Soil	Soft Soil	Medium Soil	Hard Soil	Chunk Rock	Soft Rock	Hard Rock
Cast Fluted		○	◐	●	●	◐	
Compact Fluted		○	◐	●	●	◐	
Beavertail	◐	●	●	●			
Water Wing	○	◐	◐	●	◐		
Three Wing Rock			○	◐	●	●	
Kodiak Cobble		○	○	◐	●	●	●
Rockmaster						●	●
Pre Cutter	●	●	●	●	○	○	

THIS CHART IS MEANT AS A GUIDELINE ONLY. SEE YOUR LOCAL DITCH WITCH DEALER FOR RECOMMENDATIONS IN YOUR AREA.

DITCH WITCH Backreamers

COMPATIBLE DITCH WITCH DRILLS

	JT520	JT920L	JT920J/921/921S	JT922	JT1220 MACH 1	JT1720 MACH 1	JT2020 MACH 1	JT2720 MACH 1	JT3020 MACH 1	JT4020 MACH 1	JT100/JT8020M1/JT7020M1	JT2720 ALL TERRAIN	JT3020 ALL TERRAIN	JT4020 ALL TERRAIN	JT100 ALL TERRAIN
CAST FLUTED 400-269							•	•	•						
CAST FLUTED 400-270							•	•	•						
CAST FLUTED 400-271							•	•	•						
CAST FLUTED 400-272							•	•	•						
CAST FLUTED 400-273							•	•	•						
CAST FLUTED 400-274							•	•	•						
CAST FLUTED 400-482										•					
CAST FLUTED 400-481										•					
CAST FLUTED 400-495										•					
CAST FLUTED 400-496										•					
CAST FLUTED 400-497										•					
CAST FLUTED 400-498										•					
CAST FLUTED 400-275										•					
CAST FLUTED 400-276										•					
CAST FLUTED 400-277										•					
CAST FLUTED 400-278										•					
COMPACT FLUTED 357-696	•	•	•	•											
COMPACT FLUTED 401-355		•	•	•	•	•	•								
COMPACT FLUTED 368-942		•	•	•	•	•	•								
COMPACT FLUTED 368-944		•	•	•	•	•	•								
COMPACT FLUTED 368-946		•	•	•	•	•	•								
BEAVERTAIL 369-198	•	•	•	•											
BEAVERTAIL 368-536	•	•	•	•											
BEAVERTAIL 368-539	•	•	•	•											
BEAVERTAIL 368-542	•	•	•	•											
BEAVERTAIL 368-545	•	•	•	•											
BEAVERTAIL 368-548	•	•	•	•											
BEAVERTAIL 369-201		•	•	•	•	•	•								
BEAVERTAIL 368-419		•	•	•	•	•	•								
BEAVERTAIL 368-424		•	•	•	•	•	•								
BEAVERTAIL 368-621		•	•	•	•	•	•								
BEAVERTAIL 368-427		•	•	•	•	•	•								
BEAVERTAIL 368-430		•	•	•	•	•	•								
BEAVERTAIL 368-433		•	•	•	•	•	•								
BEAVERTAIL 400-323							•	•	•						
BEAVERTAIL 400-324							•	•	•						
BEAVERTAIL 400-325							•	•	•						
BEAVERTAIL 400-326							•	•	•						
BEAVERTAIL 400-327							•	•	•						
BEAVERTAIL 400-328							•	•	•						
BEAVERTAIL 400-1339										•					
BEAVERTAIL 400-1338										•					
BEAVERTAIL 400-1337										•					
BEAVERTAIL 400-1336										•					
BEAVERTAIL 400-1335										•					
BEAVERTAIL 400-1344										•					
BEAVERTAIL 400-1322										•					

COMPATIBLE DITCH WITCH DRILLS

	JT520	JT920L	JT920J/921/921S	JT922	JT1220 MACH 1	JT1720 MACH 1	JT2020 MACH 1	JT2720 MACH 1	JT3020 MACH 1	JT4020 MACH 1	JT100/JT8020M1	JT2720 ALL TERRAIN	JT3020 ALL TERRAIN	JT4020 ALL TERRAIN	JT100 ALL TERRAIN
WATER WING 369-782	•	•		•	•	•									
WATER WING 369-783	•	•		•	•	•									
WATER WING 369-784	•	•		•	•	•									
WATER WING 369-785	•	•		•	•	•									
WATER WING 400-205							•	•	•						
WATER WING 400-206							•	•	•	•					
WATER WING 400-186							•	•	•	•					
WATER WING 400-187							•	•	•	•					
WATER WING 400-188							•	•	•	•					
WATER WING 400-189							•	•	•						
WATER WING 369-236										•					
WATER WING 369-237										•					
WATER WING 369-238										•					
WATER WING 369-239										•					
WATER WING 369-240										•					
WATER WING 369-241										•					
THREE WING ROCK 369-587	•	•	•	•	•	•									
THREE WING ROCK 369-588	•	•	•	•	•	•									
THREE WING ROCK 369-589	•	•	•	•	•	•									
THREE WING ROCK 369-590	•	•	•	•	•	•									
THREE WING ROCK 369-591	•	•	•	•	•	•									
THREE WING ROCK 369-592	•	•	•	•	•	•									
THREE WING ROCK 369-593	•	•	•	•	•	•									
THREE WING ROCK 400-355							•	•	•		•	•	•	•	
THREE WING ROCK 400-356							•	•	•		•	•	•	•	•
THREE WING ROCK 400-357							•	•	•		•	•	•	•	•
THREE WING ROCK 400-358							•	•	•		•	•	•	•	•
THREE WING ROCK 400-359							•	•	•		•	•	•	•	•
THREE WING ROCK 400-360							•	•	•		•	•	•	•	•
THREE WING ROCK 369-548										•					
THREE WING ROCK 369-549										•					
THREE WING ROCK 369-550										•					
THREE WING ROCK 369-551										•					
THREE WING ROCK 369-552										•					
THREE WING ROCK 369-553										•					
THREE WING ROCK 369-554										•					
KODIAK COBBLE 369-660	•	•	•	•	•	•									
KODIAK COBBLE 369-661	•	•	•	•	•	•									
KODIAK COBBLE 369-662	•	•	•	•	•	•									
KODIAK COBBLE 369-663	•	•	•	•	•	•									
KODIAK COBBLE 369-664	•	•	•	•	•	•									
KODIAK COBBLE 400-329							•		•						
KODIAK COBBLE 400-330							•	•	•		•	•	•	•	
KODIAK COBBLE 400-331							•	•	•		•	•	•	•	•
KODIAK COBBLE 400-332							•	•	•		•	•	•	•	•
KODIAK COBBLE 400-333							•	•	•		•	•	•	•	•
KODIAK COBBLE 400-334							•	•	•		•	•	•	•	•

DITCH WITCH Backreamers

COMPATIBLE DITCH WITCH DRILLS

	JT520	JT920L	JT920J/921/921S	JT922	JT1220 MACH 1	JT1720 MACH 1	JT2020 MACH 1	JT2720 MACH 1	JT3020 MACH 1	JT4020 MACH 1	JT100/JT8020M1/JT7020M1	JT2720 ALL TERRAIN	JT3020 ALL TERRAIN	JT4020 ALL TERRAIN	JT100 ALL TERRAIN
KODIAK COBBLE 369-667															
KODIAK COBBLE 369-668															
KODIAK COBBLE 369-669															
KODIAK COBBLE 400-1213															
KODIAK COBBLE 400-1214															
KODIAK COBBLE 400-1215															
KODIAK COBBLE 400-1216															
KODIAK COBBLE 400-1217															
ROCKMASTER 190-1403															
ROCKMASTER 190-1404															
ROCKMASTER 190-1391															
ROCKMASTER 190-1392															
ROCKMASTER 190-1393															
ROCKMASTER 190-1394															
ROCKMASTER 190-1395															
ROCKMASTER 190-1396															
ROCKMASTER 190-1397															
ROCKMASTER 190-1398															
ROCKMASTER 190-1399															
ROCKMASTER 190-1400															
ROCKMASTER 190-1401															
ROCKMASTER 190-1402															
ROCKMASTER 190-1405															
ROCKMASTER 190-1406															
ROCKMASTER 190-1407															
ROCKMASTER 190-1408															
ROCKMASTER 190-1409															
ROCKMASTER 190-1410															
ROCKMASTER 190-1411															
ROCKMASTER 190-1412															
PRE CUTTER 368-354															
PRE CUTTER 401-008															
PRE CUTTER 400-614															
PRE CUTTER 400-102															

DITCH WITCH Nozzles

By regulating and directing the fluid flow in backreamers and beacon housings, Ditch Witch nozzles play an essential role in maximizing the efficiency of your Ditch Witch directional drill. We offer a wide variety of nozzles—with varying flows and pressures—to meet virtually any application. Whether they are manufactured from heat-treated steel or fabricated with carbide inserts, Ditch Witch nozzles are made to withstand the rigorous conditions experienced downhole. Ask your Ditch Witch dealer for the best nozzle type and configuration for your soil conditions.

NOZZLES

PART NUMBER	THREAD SIZE	ORIFICE SIZE	TYPE
149-200	1/4 NPT	.070 IN	SINGLE JET
149-201	1/4 NPT	.100 IN	SINGLE JET
149-202	1/4 NPT	.150 IN	SINGLE JET
149-203	1/4 NPT	.200 IN	SINGLE JET
149-204	1/4 NPT	.250 IN	SINGLE JET
159-297	7/16-20	.074 IN	SINGLE JET
159-293	7/16-20	.104 IN	SINGLE JET
159-423	7/16-20	.188 IN	SINGLE JET
159-295	7/16-20	.074 IN	ANGLED JET
159-422	7/16-20	.156 IN	ANGLED JET
159-291	7/16-20	.209 IN	ANGLED JET
159-296	7/16-20	.074 IN	DUAL JET
159-292	7/16-20	.104 IN	DUAL JET
159-294	7/16-20	N/A	PLUG
159-407	7/8-14	.104 IN	SINGLE JET
159-405	7/8-14	.157 IN	SINGLE JET
159-397	7/8-14	.209 IN	SINGLE JET
159-406	7/8-14	.104 IN	ANGLED JET
159-404	7/8-14	.157 IN	ANGLED JET
159-396	7/8-14	.209 IN	ANGLED JET
159-398	7/8-14	N/A	PLUG



DITCH WITCH Pullers

When it's time to pull back new pipe through the bore, make sure you have a reliable connection to the drill string with a super-strong Ditch Witch puller. Our pullers are one-piece units that screw into the leading edge of the PVC, and are adaptable to a wide range of pipe sizes. We offer an extensive selection of pullers for a variety of applications.

CLEVIS

PART NUMBER	SIZE
110-289	5/16 IN
110-509	1/2 IN
110-969	5/8 IN
110-040	3/4 IN
110-987	7/8 IN
110-874	1 IN
111-018	1-1/4 IN
111-019	1-1/2 IN
369-709	BIT CLEVIS



PULLING GRIP WITH SWIVEL

PART NUMBER	SIZE
185-901	3/8 IN - 1/2 IN
185-902	1/2 IN - 3/4 IN
185-903	3/4 IN - 1-1/4 IN
185-904	1-1/4 IN - 2 IN
185-906	2 IN - 2-3/4 IN
185-907	2-3/4 IN - 3-1/2 IN
185-913	3-1/2 IN - 4-1/4 IN
185-914	4-1/4 IN - 4-3/4 IN



PULLING GRIP WITHOUT SWIVEL

PART NUMBER	SIZE
185-917	3/4 IN - 1-1/4 IN
185-918	1-1/4 IN - 2 IN
185-919	2 IN - 2-3/4 IN
185-920	2-3/4 IN - 3-1/2 IN
185-921	3-1/2 IN - 4-1/4 IN



HEAVY-DUTY PULLING GRIP

PART NUMBER	SIZE
185-922	3/4 IN - 1-1/4 IN
185-923	1-1/4 IN - 2 IN
185-924	2 IN - 2-3/4 IN
185-925	2-3/4 IN - 3-1/2 IN
185-926	3-1/2 IN - 4-1/4 IN



PIPE PULLER

PART NUMBER	SIZE
368-290	5/8 IN - 1-1/4 IN



PULL CLEVIS

PART NUMBER	SIZE
368-234	1.94-4 F/12K PULL CLEVIS
400-781	2.77-4 DS AT F/30K PULL CLEVIS
400-805	2.77-4 SS AT F/30K PULL CLEVIS
400-820	3.25-4 AT F/40K PULL CLEVIS



DITCH WITCH Pullers

COMPATIBLE DITCH WITCH DRILLS

	JT520	JT920L	JT920J/921/921S	JT922	JT1220 MACH 1	JT1720 MACH 1	JT2020 MACH 1	JT2720 MACH 1	JT3020 MACH 1	JT4020 MACH 1	JT100/JT8020M1	JT2720 ALL TERRAIN	JT3020 ALL TERRAIN	JT4020 ALL TERRAIN	JT100 ALL TERRAIN
CLEVIS 110-289	•														
CLEVIS 110-509	•	•	•	•	•	•	•								
CLEVIS 110-969	•	•	•	•	•	•	•								
CLEVIS 110-040		•	•	•	•	•	•	•	•						
CLEVIS 110-987		•	•	•	•	•	•	•	•	•	•	•	•	•	•
CLEVIS 110-874									•	•	•	•	•	•	•
CLEVIS 111-018											•				
CLEVIS 111-019											•				
CLEVIS 369-709	•														
PULLING GRIP, SWIVEL 185-901	•														
PULLING GRIP, SWIVEL 185-902	•	•	•	•											
PULLING GRIP, SWIVEL 185-903	•	•	•	•											
PULLING GRIP, SWIVEL 185-904	•	•	•	•			•	•							
PULLING GRIP, SWIVEL 185-906	•	•	•	•			•	•							
PULLING GRIP, SWIVEL 185-907	•	•	•	•			•	•							
PULLING GRIP, SWIVEL 185-913	•	•	•	•			•	•							
PULLING GRIP, SWIVEL 185-914	•	•	•	•			•	•							
PULLING GRIP 185-917	•	•	•	•	•	•	•	•	•	•	•	•	•	•	•
PULLING GRIP 185-918	•	•	•	•	•	•	•	•	•	•	•	•	•	•	•
PULLING GRIP 185-919	•	•	•	•	•	•	•	•	•	•	•	•	•	•	•
PULLING GRIP 185-920	•	•	•	•	•	•	•	•	•	•	•	•	•	•	•
PULLING GRIP 185-921	•	•	•	•	•	•	•	•	•	•	•	•	•	•	•
HD PULLING GRIP 185-922	•	•	•	•	•	•	•	•	•	•	•	•	•	•	•
HD PULLING GRIP 185-923	•	•	•	•	•	•	•	•	•	•	•	•	•	•	•
HD PULLING GRIP 185-924	•	•	•	•	•	•	•	•	•	•	•	•	•	•	•
HD PULLING GRIP 185-925	•	•	•	•	•	•	•	•	•	•	•	•	•	•	•
HD PULLING GRIP 185-926	•	•	•	•	•	•	•	•	•	•	•	•	•	•	•
PIPE PULLER 368-290	•	•	•	•	•	•									
PULL CLEVIS 368-234	•	•	•												
PULL CLEVIS 400-781											•	•			
PULL CLEVIS 400-805											•	•			
PULL CLEVIS 400-820													•	•	

DITCH WITCH Swivels

To ensure outstanding dependability, Ditch Witch swivels are designed and tested to perform under the full rotation and full torque of the drill rig, bore after bore. Built to last up to four times longer than their aftermarket counterparts, Ditch Witch swivels are every bit as sturdy as the drills that pull them. Available are standard single-tab swivels, double-clevis swivels, and swivels that attach directly to the backreamer.

DOUBLE CLEVIS

PART NUMBER	CONNECTION
185-935	5K CLEVIS/5K CLEVIS
401-283	20K CLEVIS/20K CLEVIS
300-1164	30K CLEVIS/30K CLEVIS
401-294	40K CLEVIS/40K CLEVIS



CLEVIS TO TAB

PART NUMBER	CONNECTION
368-513	12K CLEVIS/12K TAB
368-634	20K CLEVIS/20K TAB
369-712	30K CLEVIS/20K TAB
300-1157	30K CLEVIS/30K TAB
400-748	40K CLEVIS/40K TAB
369-971	70K CLEVIS/40K TAB
369-972	70K CLEVIS/70K TAB



SOCKET TO TAB

PART NUMBER	CONNECTION
300-1162	40K SOCKET F/30K TAB
300-1159	40K SOCKET F/30K TAB
400-221	40K SOCKET/40K TAB
400-759	40K SOCKET/40K TAB



DITCH WITCH Swivels

MALE TO TAB

PART NUMBER	SIZE
400-111	1.94-4M/12K TAB
400-112	1.94-4M/20K TAB
300-1158	1.94-4M/30K TAB
300-1161	2.11-4M/30K TAB
300-1163	3.25-4M/30K TAB



FEMALE TO TAB

PART NUMBER	SIZE
369-195	1.94-4F/12K TAB
400-236	1.94-4F/20K TAB
300-1160	1.94-4F/30K TAB



COMPATIBLE DITCH WITCH DRILLS

[illegible]

DITCH WITCH Tabs

Why Ditch Witch pulling tabs versus the rest? Our pulling tabs are made from hardened steel and tested to withstand the pull of each machine with which they are rated. Ditch Witch pulling tabs are designed for superior performance within the overall Ditch Witch downhole tool system. The same proprietary gauges used on our tabs are used on all other Ditch Witch downhole components, ensuring the truest, tightest connections possible all along the drill string. Connectors are available to make a 100K (445 kN) tab compatible with a 40K (180 kN) swivel.

PULL TAB

PART NUMBER	DESCRIPTION	MODEL(S)
369-308	1.21-6M API TO 5K TAB	JT520
369-309	1.31-6F EZ2 TO 5K TAB	JT520
368-352	1.41-6M TO 12K TAB	JT920/JT920L/JT921/JT921S/JT922
400-921	1.88-6F EZ3 TO 10K TAB	JT1220 MACH 1
401-007	1.88-6F EZ3 TO 20K TAB	JT1220 MACH 1
369-864	1.94-4M TO 10K TAB	JT920L/JT1220 MACH 1
369-865	1.94-M TO 20K TAB	JT920/JT920L/JT921/JT921S/JT922/JT1220 MACH 1/ JT1720 MACH 1/JT2020 MACH 1
401-246	3.25-4AT M TO 30K TAB	JT4020 ALL TERRAIN
400-818	3.25-4AT M TO 40K TAB	JT4020 ALL TERRAIN
369-123	3.27-4M TO 70K TAB	JT8020 MACH 1/JT100 MACH 1
369-122	3.27-4F TO 70K TAB	JT8020 MACH 1/JT100 MACH 1
400-583	40K SOCKET TO 30K TAB	3.5 IN SHAFT REAMERS
400-704	40K SOCKET TO 40K TAB	JT4020 MACH 1/JT4020 ALL TERRAIN
369-854	70K CLEVIS TO 40K TAB	JT4020 MACH 1/JT8020 MACH 1/JT100 MACH 1
400-760	2.77-4AT M TO 30K TAB	JT2720 ALL TERRAIN/JT3020 ALL TERRAIN
400-803	2.77-4AT M TO 30K TAB	JT2720 ALL TERRAIN/JT3020 ALL TERRAIN COBBLE



DITCH WITCH Electronic Guidance

Ditch Witch beacons and accessories are designed, tested, and manufactured to maximize the performance of your Ditch Witch electronic guidance system.

86 SERIES BEACON

DESIGNED FOR THE 750 AND 752 GUIDANCE SYSTEMS, OUR 86-SERIES BEACONS FEATURE RUBBER END CAPS, SECURE HARDWARE BATTERY CONTACTS, AND DOUBLE SPRINGS ON BATTERY FITTINGS TO PROTECT AGAINST SHOCK AND VIBRATION.

PRODUCT	DESCRIPTION	BATTERY	LIFE	RANGE
86BI	IMPACT BEACON FOR 3", 4" & 5.5" PIERCING TOOLS	(4) "AAA"	120 HRS	25 FT
86B	STANDARD RANGE, HDD BEACON	(2) "C"	60 HRS	50 FT
86BG	STANDARD RANGE, CRITICAL PITCH (GRADE) HDD BEACON	(2) "C"	40 HRS	50 FT
86BH	HIGH RANGE, HDD BEACON OPTION	(2) "C"	16 HRS	70 FT
86BD	DUAL FREQUENCY, HDD BEACON OPTION	(2) "C"	14/40 HRS	50/70 FT
86BHX	EXTREME RANGE, STANDARD PITCH HDD BEACON	(1) "LITH CC"	10 HRS	80 FT
86BHL	STANDARD RANGE, HDD BEACON FOR LARGE JT	(4) "D PACK"	45 HRS	70 FT
88B	SHORT RANGE, HDD BEACON FOR SMALL JT	(1) "AA"	10 HRS	30 FT
88B/AT	SHORT RANGE, HDD BEACON FOR ROCKMASTER	(1) "AA"	22 HRS	30 FT



850 SERIES BEACON

COMPATIBLE WITH OUR INNOVATIVE BUT EASY-TO-USE 8500 GUIDANCE SYSTEM, WHICH FEATURES OFFSET LOCATING AND DEPTH-READING ABILITY SO YOU CAN DETERMINE DEPTH AND HORIZONTAL OFFSET ALONGSIDE THE BEACON—EVEN NEXT TO SIDEWALKS AND AROUND TREES, BRUSH, AND OTHER OBSTACLES.

PRODUCT	DESCRIPTION	BATTERY	LIFE	RANGE
850B	STANDARD RANGE, HDD BEACON	(2) "C"	30 HRS	50 FT
850BG	CRITICAL PITCH (GRADE) HDD BEACON	(2) "C"	30 HRS	50 FT
850BH	HIGH RANGE, HDD BEACON OPTION	(2) "C"	20 HRS	60 FT
850BD	DUAL FREQUENCY, HDD BEACON OPTION	(2) "C"	20/30 HRS	30/50 FT
850BHD	HIGH RANGE, DUAL FREQUENCY OPTION	(2) "C"	20 HRS	40/60 FT



GUIDANCE ACCESSORIES & REPLACEMENT PARTS

PART NUMBER	DESCRIPTION
214-911	LITHIUM BATTERY 88B
219-325	ISOLATOR 86B
220-051	86BHL HOUSING CANOE (86/850)
220-054	TRAC MANAGEMENT SYSTEM (TMS) PLUS
220-083	SILVER LITHIUM "CC" BATTERY
220-378	POWER PACK ASSEMBLY 86BHL
220-413	CASE ASSEMBLY FOR 86B & 86BH
220-482	CASE ASSEMBLY FOR 86BHL
220-501	CASE ASSEMBLY FOR 86BG BEACON
220-575	DISPLAY STAND-ALONE CASE, 700 SERIES
220-634	CASE ASSEMBLY FOR 88B
220-643	EXTERNAL REMOTE ANTENNA WITH 50' CABLE, 700 SERIES
220-1051	CASE ASSEMBLY FOR 86B
220-1090	CASE ASSEMBLY FOR 8500 SERIES
221-086	ISOLATOR 86BHL

PART NUMBER	DESCRIPTION
221-461	DIGITAL LEVEL
221-543	ISOLATOR 88B
221-577	FLAT TOP, STANDARD SIDE-LOAD ISOLATOR 86B
221-936	HARD CASE
222-071	STAND, 700 SERIES
222-500	AFT ISOLATOR, 850 SERIES
222-501	FORWARD ISOLATOR, 850 SERIES
222-1369	BLUE POWER STICK "CC" BATTERY
400-1121	HALF-MOON ISOLATOR CANOE FOR DCI BEACONS
401-278	CANOE, 88B, JT520
401-279	CANOE, 88B, UPPER JT1220 HOUSING
401-280	CANOE, 88B, LOWER JT1220 HOUSING
220-1089	DISPLAY STAND-ALONE CASE, 8500 SERIES
400-1151	FLAT-TOP ISOLATOR CANOE FOR DCI BEACONS

DITCH WITCH Pipe & Cable Locating

All components of Ditch Witch pipe- and cable-locating systems—transmitters, receivers, beacons and accessories—are designed, tested, and manufactured to maximize performance.

150 CABLE AVOIDANCE SYSTEM

AN EASY, AFFORDABLE WAY TO DETECT OBSTACLES BENEATH THE SURFACE, SO YOU CAN DIG A POSTHOLE OR FOOTING, INSTALL A FRENCH DRAIN, OR LAY FIBER-OPTIC CABLE WITH CONFIDENCE. WEIGHING JUST OVER 5 LB (2.3 KG), THE LIGHTWEIGHT, COMPACT 150R/T IS AS EASY TO CARRY AS IT IS TO OPERATE.

PRODUCT	DESCRIPTION	BATTERY	LIFE	WEIGHT
150R	RECEIVER WITH ONE ACTIVE FREQUENCY AND POWER	(2) "C"	40 HRS	2 LBS
150T	TRANSMITTER WITH ONE ACTIVE FREQUENCY	(6) "C"	40 HRS	3 LBS

PRODUCT	DESCRIPTION	BATTERY	LIFE	RANGE
150BW	SHORT RANGE, WATER/SEWER BEACON	(1) "N"	4 HRS	12 FT
150BC	SHORT RANGE, PLASTIC PIPE OR CONDUIT BEACON	(1) "N"	4 HRS	10 FT
150BWL	LONG RANGE, WATER/SEWER BEACON	(1) "AA"	4 HRS	30 FT
150BCL	LONG RANGE, PLASTIC PIPE OR CONDUIT BEACON	(1) "AA"	4 HRS	30 FT



150 SERIES ACCESSORIES

PART NUMBER	DESCRIPTION
220-131	GROUND PIN
220-192	DIRECT CONNECT LEADS
220-292	5 INCH ROUND INDUCTIVE CLAMP
220-339	3 INCH ROUND INDUCTIVE CLAMP
220-455	7 INCH ROUND INDUCTIVE CLAMP
220-566	LIVE POWER ADAPTOR
220-674	LIVE POWER CABLE ADAPTOR
220-1108	150B FLEX-ROD ADAPTER KIT
222-1132	CARRY BAG



250 SERIES PIPE & CABLE LOCATING SYSTEM

ONE OF THE MOST EFFICIENT AND COST-EFFECTIVE METHODS FOR LOCATING AND AVOIDING BURIED TELEPHONE, CATV, POWER, GAS, AND WATER LINES. THIS SIMPLE, LIGHTWEIGHT RECEIVER/TRANSMITTER SYSTEM FEATURES INTUITIVE CONTROLS, AN EASY-TO-READ DISPLAY, AND DEPTH ESTIMATION UP TO 15 FEET (4.6 M).

PRODUCT	DESCRIPTION	BATTERY	LIFE	WEIGHT
250R	RECEIVER WITH ONE ACTIVE FREQUENCY AND POWER	(6) "C"	40 HRS	5 LBS
250T	TRANSMITTER WITH ONE ACTIVE FREQUENCY	(6) "D"	150 HRS	5 LBS



DITCH WITCH Pipe & Cable Locating

250 SERIES ACCESSORIES

PART NUMBER	DESCRIPTION
220-046	CARRY BAG W/POCKETS
220-131	GROUNDING PIN, 250
220-373	TELEPHONE LEAD ADAPTER (ALLIGATOR CLIP)
220-483	5 INCH ROUND INDUCTIVE CLAMP
220-485	3 INCH ROUND INDUCTIVE CLAMP
220-487	7 INCH ROUND INDUCTIVE CLAMP
220-496	CLAMP 10' EXTENSION
220-497	TELEPHONE DIRECT CONNECT
220-566	LIVE POWER ADAPTOR (LPA)
220-671	CARRY BAG
222-132	REPLACEMENT DIRECT CONNECT LEADS
222-169	HARD CASE



900 SERIES ACCESSORIES

PRODUCT	DESCRIPTION	BATTERY	LIFE	WEIGHT
11B	SHORT RANGE, PLASTIC PIPE OR CONDUIT BEACON	(1) "AAA"	14 HRS	15 FT
910B	SHORT RANGE, WATER/SEWER BEACON	(2) "AA"	16 HRS	10 FT

PART NUMBER	DESCRIPTION
220-442	STRAIGHT LEADS
220-1077	FAULT LEADS
220-336	LONG GROUNDING PIN
220-1132	REMOTE PROBE CABLE
222-2791	FOAM HANDLE



720ML MAGNETIC LOCATOR

WITH ITS RUGGED DURABILITY, UNMATCHED SENSITIVITY, AND SIMPLE OPERATION, THE DITCH WITCH 720ML MAGNETIC LOCATOR IS DESIGNED TO ENSURE THAT YOU NEVER MISS A MARKER STAKE, MANHOLE COVER, VALVE BOX, OR CAST-IRON PIPE AGAIN.

PRODUCT	DESCRIPTION	BATTERY	LIFE	WEIGHT
720ML	MAGNETIC LOCATOR	(2) "9V LITH"	60 HRS	2.5 LBS



DITCH WITCH Vacuum Excavation

Ditch Witch vacuum excavation systems take care of all types of spills and unwanted fluids while taking care of your ears. And our accessories are designed, tested, and manufactured to maximize the performance of your Ditch Witch vacuum excavation system.

TOOLS

PART NUMBER	DIAMETER	DESCRIPTION	LENGTH	MODEL(S)
101-138	N/A	LAWN SWEEPER	N/A	FX20/FX30/FX60
310-893	3 IN	SUCTION TOOL	N/A	FX20/FX30/FX60
315-651	3 IN	SUCTION TOOL	7 FT	FX20/FX30/FX60
315-652	3 IN	SUCTION TOOL	10 FT	FX30/FX60
319-539	4 IN	SUCTION TOOL	N/A	FX30/FX60
310-894	3 IN	2-1 TOOL	N/A	FX30
325-411	4 IN	2-1 TOOL	N/A	FX30/FX60
314-358	3 IN	2-1 TOOL EXTENSION	5 FT	FX30
314-379	3 IN	2-1 TOOL EXTENSION	3 FT	FX30
319-527	4 IN	TOOL EXTENSION (WORKS ON 4" 2-1 TOOL AND 4" SUCTION TOOL)	3 FT	FX30/FX60
101-139	4 IN	VAC TOOL KIT (INCLUDES: 319-527, 325-411, 319-539)	N/A	FX30/FX60



HOSES

PART NUMBER	DIAMETER	DESCRIPTION	LENGTH	MODEL(S)
310-861	3 IN	HOSE EXTENSION KIT ONE PIECE	15 FT	FX30
315-721	3 IN	HOSE EXTENSION KIT/ONE PIECE	25 FT	FX20/FX30
318-652	3 IN	HOSE EXTENSION KIT/ONE PIECE	50 FT	FX20/FX30
100-859	4 IN	HOSE EXTENSION KIT/ONE PIECE	25 FT	FX30/FX60
100-860	4 IN	HOSE EXTENSION KIT/ONE PIECE	50 FT	FX30/FX60
100-582	3 IN	HOSE EXTENSION KIT/TWO PIECE	30 FT	FX30
100-583	3 IN	HOSE EXTENSION KIT/TWO PIECE	50 FT	FX30
100-573	4 IN	HOSE EXTENSION KIT/TWO PIECE	30 FT	FX30/FX60
310-862	3 IN	SUCTION HOSE ASSEMBLY F/F	N/A	FX30
100-566	3 IN	HOSE KIT/ONE PIECE	25 FT	FX30
100-558	3 IN	HOSE KIT/ONE PIECE	50 FT	FX30
100-556	3 IN	HOSE KIT/TWO PIECE	30 FT	FX30
100-557	3 IN	HOSE KIT/TWO PIECE	50 FT	FX30
320-799	4 IN	HOSE	15 FT	FX60
320-800	4 IN	HOSE	25 FT	FX60
320-801	4 IN	HOSE	50 FT	FX60



FILTERS

PART NUMBER	DESCRIPTION	MODEL(S)
195-1200	VAC FILTER	FX20/FX30/FX60
153-495	VAC PRE-FILTER (2.500)	FX20/FX30/FX60
153-678	WATER STRAINER (12N, 80 MESH)	FX30/FX60
159-331	INLINE STRAINER (12NF, NYL)	FX20



ACCESSORIES

PART NUMBER	DESCRIPTION	MODEL(S)
150-2023	2.6 GPM TURBO SPRAY NOZZLE	FX20
401-029	TURBO SPRAY GUN NOZZLE	FX30/FX60
117-596	56" STEEL VAC WAND HANDLE	FX20/FX30/FX60
318-647	WASH WAND KIT	FX30
350-2031	FX60 SPRAY LANCE	FX60
101-122	WATER HOSE EXTENSION KIT (CAN BE USED WITH WASH WAND AND 2-1 TOOL)	FX30/FX60
100-549	WATER LANCE EXTENSION (36") (EXTENDS 318-647 TO 6')	FX30/FX60
159-556	HOSE, 220" (MUST ORDER TWO WHEN ORDERING A UNIT WITHOUT THE VACUUM HOSE REEL ASSEMBLY)	FX60
217-098	WORK LAMP, MAGNETIC	FX20



DITCH WITCH Piercing Tools

Ditch Witch piercing tools' straightforward design makes them easy to use and among the most productive tools available for short- to medium-range stitch boring projects, pipe ramming and pushing, and pipe pulling under roads, driveways, railroad tracks, sidewalks, and other obstructions.

PT20 PACKAGE

PART NUMBER	DESCRIPTION
104-071	2.25 IN QUICK-REVERSE PIERCING TOOL
310-108	OILER ASSEMBLY
120-100	50 FT HOSE ASSEMBLY



PT30 PACKAGE

PART NUMBER	DESCRIPTION
104-072	3.25 IN QUICK-REVERSE PIERCING TOOL
310-108	OILER ASSEMBLY
120-100	50 FT HOSE ASSEMBLY



AIR HOSES

PART NUMBER	LENGTH	DESCRIPTION	MODEL
120-100	50 FT	THERMOPLASTIC HOSE ASSEMBLY	PT20, PT30
120-101	50 FT	THERMOPLASTIC EXTENSION HOSE ASSEMBLY	PT20, PT30
120-129	75 FT	TWIN THERMOPLASTIC HOSE ASSEMBLY	PT20, PT30
120-145	50 FT	TWIN RUBBER HOSE ASSEMBLY	PT20
120-102	50 FT	SINGLE-BRAIDED RUBBER HOSE ASSEMBLY	PT30
120-103	50 FT	SINGLE-BRAIDED RUBBER EXTENSION HOSE ASSEMBLY	PT30



PT30 REPLACEABLE HEADS

PART NUMBER	DESCRIPTION	RECOMMENDED SOIL CONDITIONS
352-913	STEPPED HEAD	SMALL ROCKS, TREE ROOTS
352-914	SPLINED STEPPED HEAD	HARD, DRY, OR COMPACTED SOIL
352-915	TAPERED HEAD	WET, SPONGY, OR LOOSE SOIL
342-005	STEPPED SIDE BEACON HEAD	SMALL ROCKS, TREE ROOTS
342-004	SPLINED STEPPED SIDE BEACON HEAD	HARD, DRY, OR COMPACTED SOIL
342-003	TAPERED SIDE BEACON HEAD	WET, SPONGY, OR LOOSE SOIL



PT30 BOLT-ON EXPANDER

PART NUMBER	DESCRIPTION
100-539	4-1/4 IN BOLT-ON REVERSIBLE EXPANDER



ACCESSORIES

PART NUMBER	DESCRIPTION
104-074	PT20 WRENCH KIT
104-075	PT30 WRENCH KIT
100-739	TOOL LAUNCHER
352-874	AIMING SIGHT
352-450	ADJUSTABLE PIPE STAND
259-131	MAGNETIC LEVEL (U.S.)
256-611	PIERCING TOOL OIL (1 QT)
256-612	PIERCING TOOL OIL (5 GAL)
256-614	WINTER PIERCING TOOL OIL (1 QT)
256-615	WINTER PIERCING TOOL OIL (5 GAL)
217-542	AIR PRESSURE GAUGE KIT
102-239	29K BEACON

Архангельск (8182)63-90-72
Астана +7(7172)727-132
Белгород (4722)40-23-64
Брянск (4832)59-03-52
Владивосток (423)249-28-31
Волгоград (844)278-03-48
Вологда (8172)26-41-59
Воронеж (473)204-51-73
Екатеринбург (343)384-55-89
Иваново (4932)77-34-06
Ижевск (3412)26-03-58
Казань (843)206-01-48

Калининград (4012)72-03-81
Калуга (4842)92-23-67
Кемерово (3842)65-04-62
Киров (8332)68-02-04
Краснодар (861)203-40-90
Красноярск (391)204-63-61
Курск (4712)77-13-04
Липецк (4742)52-20-81
Магнитогорск (3519)55-03-13
Москва (495)268-04-70
Мурманск (8152)59-64-93
Набережные Челны (8552)20-53-41

Нижний Новгород (831)429-08-12
Новокузнецк (3843)20-46-81
Новосибирск (383)227-86-73
Орел (4862)44-53-42
Оренбург (3532)37-68-04
Пенза (8412)22-31-16
Пермь (342)205-81-47
Ростов-на-Дону (863)308-18-15
Рязань (4912)46-61-64
Самара (846)206-03-16
Санкт-Петербург (812)309-46-40
Саратов (845)249-38-78

Смоленск (4812)29-41-54
Сочи (862)225-72-31
Ставрополь (8652)20-65-13
Тверь (4822)63-31-35
Томск (3822)98-41-53
Тула (4872)74-02-29
Тюмень (3452)66-21-18
Ульяновск (8422)24-23-59
Уфа (347)229-48-12
Челябинск (351)202-03-61
Череповец (8202)49-02-64
Ярославль (4852)69-52-93